

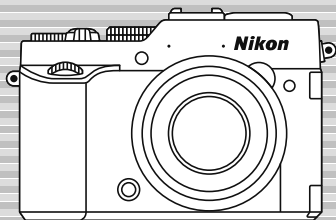

Quick Start Guide

Confirming the Package Contents	3
First Steps	6
Shooting and Playback	14
Using ViewNX 2	21
Other Functions	27
For Your Safety	36



En

COOLPIX P7800

Thank you for purchasing the Nikon COOLPIX P7800 digital camera. This guide introduces the procedures necessary for first time use of this camera.

To ensure proper use, please read and thoroughly understand the information provided in "For Your Safety" (□36) before using the camera.

For more detailed information, please refer to the digital *Reference Manual*, which is located on the included CD-ROM. For information on viewing the camera's digital *Reference Manual*, see "Viewing the Reference Manual CD" described below.

Should you need technical support, we offer a number of options.

Internet

Please visit the Nikon support home page, where you can:

- Search Nikon's continuously updated Knowledge Database for the latest technical support information.
- Use "Ask Nikon a Question" to receive a prompt reply from a Nikon professional advisor to your e-mail.
- Download the latest versions of Nikon software or firmware updates for your product, or register to receive e-mail notification for software or firmware updates.

For customers in the United States: **www.nikontechusa.com**

For customers in Canada: **help.nikon.ca** (English), **nikoncanada-fr.custhelp.com** (Français)

For customers in Mexico: **nikon.com.mx/soporte**

For customers in Brazil: **<http://nikon.com.br>**

Telephone

Please call for technical support and other product assistance. Our professional advisers are standing by to help with your digital camera needs.

For customers in the United States: **1-800-NIKON-UX (1-800-645-6689)**

For customers in Canada: **1-877-534-9910**

For customers in Mexico: **001-888-565-5452**

For customers in Brazil: **0800-886-4566 (0800-88 NIKON)**



Viewing the "Reference Manual CD"

The *Reference Manual* can be viewed using Adobe Reader, available for free download from the Adobe website.

- 1 Start the computer and insert the "Reference Manual CD".
- 2 Double-click the CD (**COOLPIX P7800**) icon in **Computer** or **My Computer** (Windows) or on the desktop (Mac OS).
- 3 Double-click the **INDEX.pdf** icon to display the language selection screen.
Click a language and follow the links to view the *Reference Manual*.

An Important Notice about Accessories

Nikon COOLPIX digital camera is designed to the highest standards and includes complex electronic circuitry. Only Nikon accessories, such as battery chargers, batteries and AC adapters are certified by Nikon specifically for your Nikon COOLPIX camera and are engineered and tested to operate within the requirements of the electronic circuitry of our cameras.

THE USE OF NON-NIKON ACCESSORIES MAY DAMAGE YOUR CAMERA AND WILL VOID YOUR NIKON WARRANTY.

Genuine Nikon accessories are available through your Nikon-authorized dealer.

Confirming the Package Contents

In the event that any items are missing, please contact the store where you purchased the camera.



COOLPIX P7800
Digital Camera
(with Accessory Shoe Cover
BS-1)



Camera Strap



Lens Cap LC-CP26
(attached to the camera
body)



Rechargeable Li-ion Battery
EN-EL14
(with terminal cover)

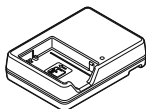

Battery Charger MH-24*

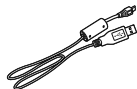

USB Cable UC-E16



ViewNX 2 CD



Reference Manual CD
(Reference Manual CD)

- Quick Start Guide (this guide)

- Warranty

* A plug adapter is included if the camera was purchased in a country or region that requires a plug adapter. The shape of the plug adapter varies with the country or region of purchase (📖6).



The included Battery Charger is MH-24 in countries other than Brazil, and MH-24C in Brazil.





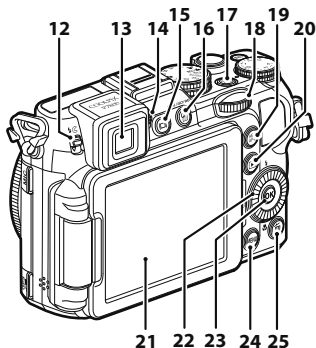
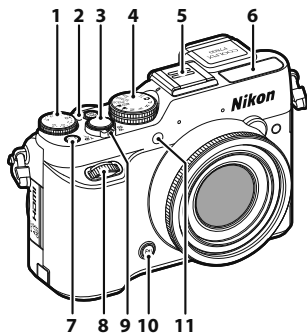

NOTE: A Secure Digital (SD) memory card, hereafter referred to as a “memory card”, is not provided.

📖: This icon indicates that more information is available elsewhere in this guide.

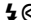
Parts of the Camera



- 1** Exposure compensation dial
- 2** Exposure compensation dial mark
- 3** Shutter-release button
- 4** Mode dial
- 5** Accessory shoe
- 6** Flash
- 7** Fn2 (function 2) button
- 8** Sub-command dial
- 9** Zoom control
W : wide-angle
T : telephoto
 : thumbnail playback
 : playback zoom
 : help
- 10** Fn1 (function 1) button

- 11** AF-assist illuminator
- 12**  (flash pop-up) control
- 13** Electronic viewfinder
- 14** Diopter adjustment control
- 15**  (monitor) button
- 16**  (quick menu) button
- 17** Power switch/power-on lamp
- 18** Main command dial
- 19** AE-L/AF-L (AE-L/AF-L) button
- 20**  (playback) button
- 21** Monitor
- 22** Rotary multi selector (multi selector)
- 23**  (apply selection) button
- 24** MENU (menu) button
- 25**  (delete) button

Opening and Adjusting the Angle of the Monitor

The orientation and tilt of the monitor can be changed. This is useful when shooting with the camera in a high or a low position, or when taking self-portraits.

For normal shooting, fold the monitor against the camera body with the screen facing out (③).

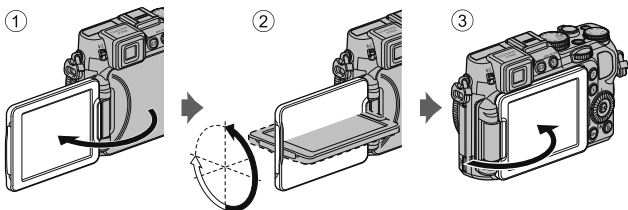

When you are not using or carrying the camera, fold the monitor against the camera body with the screen facing inward to prevent scratches or contamination.



✓ Notes About the Monitor

- When moving the monitor, do not apply excessive force and turn slowly within the monitor's adjustable range so that the connection will not be damaged.
- When the monitor is turned with a cable connected to the external microphone connector or accessory terminal, the monitor may catch on the cable or cover. Do not apply excessive force to the cable or to the connector of the camera.

First Steps

Step 1 Charge the Battery

1.1 Prepare the included battery charger.

If a plug adapter* is included with your camera, attach the plug adapter to the plug on the battery charger. Push the plug adapter firmly until it is securely held in place. Once the two are connected, attempting to forcibly remove the plug adapter could damage the product.

* The shape of the plug adapter varies according to the country or region in which the camera was purchased.

This step can be omitted if the plug adapter comes permanently bonded to the battery charger.

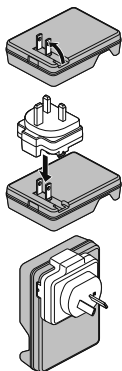

1.2 While pushing in the battery (①), set it into the battery charger (②).

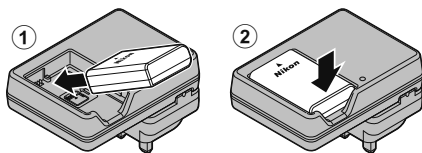

1.3 Plug the battery charger into an electrical outlet.

- CHARGE lamp starts flashing when charging starts.
 - CHARGE lamp turns on when charging is complete.
- About 1 hour and 30 minutes are required to charge a fully exhausted battery.

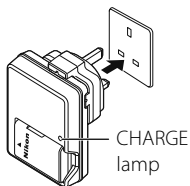

1.4 When charging is complete, remove the battery and then disconnect the battery charger from the electrical outlet.

Step 2 Attaching the Camera Strap

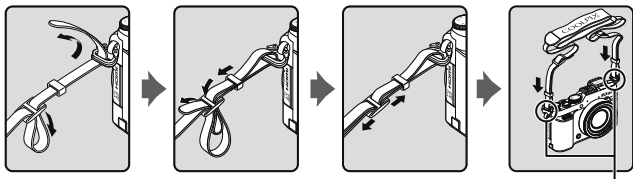

Attach the strap at two places.

Step 3 Insert the Battery and the Memory Card

3.1 Open the battery-chamber/memory card slot cover.

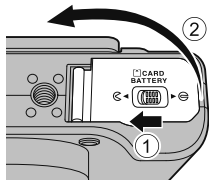

3.2 Insert the battery.

- Push the orange battery latch in the direction indicated by the arrow (①), and fully insert the battery (②).
- The battery locks into place when inserted correctly.

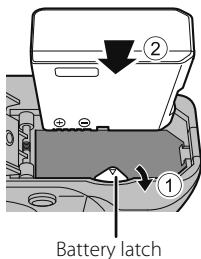

⚠ Be Careful to Insert the Battery in Correct Direction

Inserting the battery upside down or backwards could damage the camera.

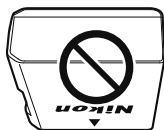

3.3 Insert the memory card.

- Slide the memory card in until it clicks into place.

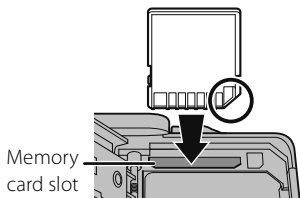

⚠ Be Careful to Insert the Memory Card in Correct Direction

Inserting the memory card upside down or backwards could damage the camera and the memory card.



3.4 Close the battery-chamber/memory card slot cover.

- While the battery-chamber/memory card slot cover is open, the camera cannot be turned on.

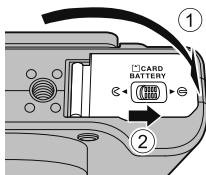

- Images are saved in the internal memory (approx. 86 MB) when no memory card is inserted in the camera.

Removing the Battery and the Memory Card

Turn the camera off and make sure that the power-on lamp and the monitor have turned off, and then open the battery-chamber/memory card slot cover.

✓ High Temperature Caution

The camera, battery, and memory card may be hot immediately after using the camera.

Removing the Battery

- Move the battery latch in the direction indicated by the arrow (①) to eject the battery (②).

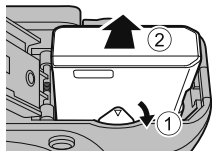

Removing the Memory Card

- Gently push the memory card into the camera (①) to partially eject the card (②).

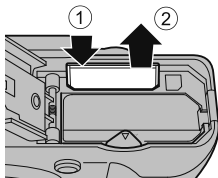

Step 4 Turn the Camera On

4.1 Open the monitor and remove the lens cap.

- See “Opening and Adjusting the Angle of the Monitor” (p. 5) for more information.



4.2 Press the power switch.

- The monitor turns on.
- To turn the camera off, press the power switch again.

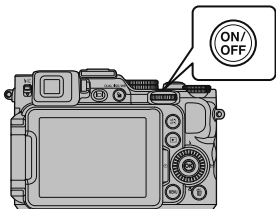

✓ Lens Cap

At times when you are not shooting images, attach the lens cap to the lens to protect it.

✎ The Auto Off Function

- If no operations are performed for a while, the monitor will turn off, the camera will enter standby mode, and the power-on lamp will flash. If no operations are performed for another 3 minutes, the camera will turn off automatically.
- While the camera is in standby mode, the monitor turns back on if you perform any of the following operations:
 - Press the power switch, shutter-release button, or  button.
 - Rotate the mode dial.
 - Open or close the monitor.

Step 5 **Setting the Display Language, Date, and Time**

When the camera is turned on for the first time, the language-selection screen and the date and time setting screen for the camera clock are displayed. Use the rotary multi selector to select the settings.

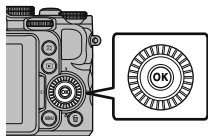

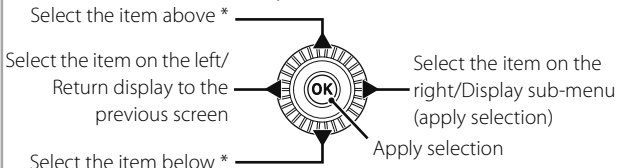

- If you exit without setting the date and time,  will flash when the shooting screen is displayed.

Rotary Multi Selector



* Items above or below can also be selected by rotating the rotary multi selector.

- 5.1** Use the multi selector   to select the desired language and press the  button.

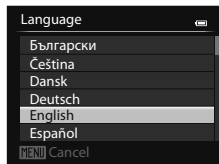

5.2 Select **Yes** and press the **OK** button.

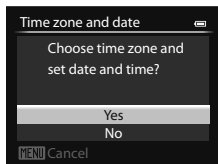

5.3 Select your home time zone and press the **OK** button.

- To enable daylight saving time, press ▲. When the daylight saving time function is enabled, ☀️ is displayed above the map. To turn off the daylight saving time function, press ▼.

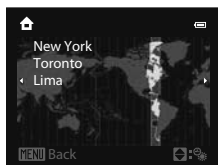

5.4 Select the date format and press the **OK** button.

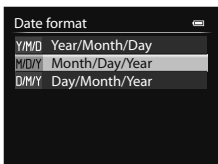

5.5 Set the date and time, and press the **OK** button.

- Select a field: Press **◀▶** (changes between **M**, **D**, **Y**, hour, and minute).
- Edit the date and time: Press **▲▼**. Date and time can also be changed by rotating the multi selector or main command dial.
- Confirm the setting: Select the minute field and press the **OK** button.

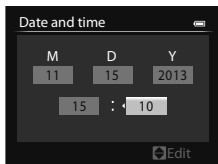

5.6 Select **Yes** and press the **OK** button.

- When settings are finished, the lens extends and the camera switches to shooting mode.

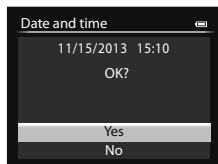

Imprinting the Date on Images While Taking Images

After setting the date and time, press the **MENU** button to display the **Y** (setup) menu and set **Print date** setting (📖33).

- Use the rotary multi selector to select and set menu options.
- Press the **MENU** button to exit the menu.

Changing the Current Date, Time, or Language

Press the **MENU** button to display the **Y** (setup) menu and set **Language or Time zone and date** (📖33).

The next step explains basic shooting operations using  (auto) mode.

Shooting and Playback

Step 1 Rotate the Mode Dial and Align the (auto) Icon to the Mark

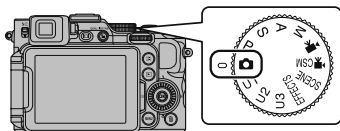

Step 2 Check the Battery Level and the Number of Exposures Remaining

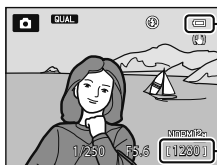



Battery level indicator

Number of exposures remaining*

* When data is recorded to the internal memory,  is displayed.

Battery level indicator

Display	Description
	The battery level is high.
	The battery level is low.
 Battery exhausted.	The camera cannot capture images. Recharge the battery.

Monitor Display

Press the **Fn2** button to switch between showing and hiding the photo information or shooting information that is displayed in the monitor.

Built-in Flash

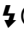
In situations where a flash is needed, such as in dark locations or when the subject is backlit, lower the  (flash pop-up) control to raise the flash.

- When not using the flash, gently push to lower the flash until it clicks shut.

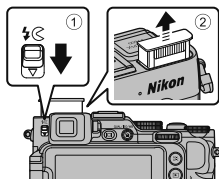

Switching Between the Monitor and Viewfinder (|◻| Button)

You can use the viewfinder when bright light under the open sky makes it difficult to see the monitor.

Each press of the |◻| button switches the display between the monitor and viewfinder.

- When you fold the monitor against the camera body with the screen facing inward, the display in the monitor is switched to the viewfinder.

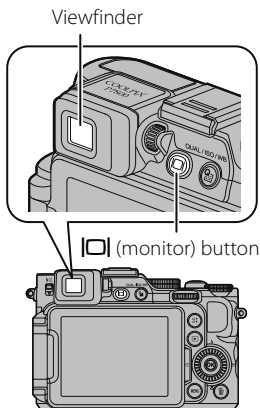

Diopter Adjustment of the Viewfinder

When the image in the viewfinder is difficult to see, adjust by rotating the diopter adjustment control while looking through the viewfinder.

- Take care not to scratch your eye with your fingertips or nails.

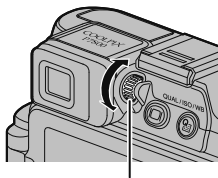

Diopter adjustment control

Step 3 *Frame a Picture*

3.1 Hold the camera steady.

- Keep fingers and other objects away from the lens, flash, AF-assist illuminator, microphone, and speaker.
- When taking pictures in portrait (“tall”) orientation, turn the camera so that the flash is above the lens.

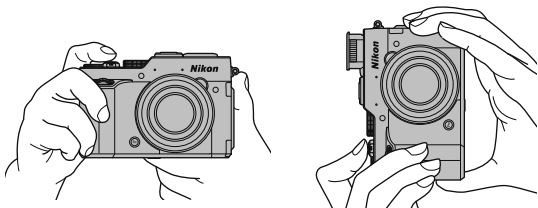

3.2 Frame the picture.



Using the Zoom

- To zoom in closer to the subject: Move toward **T** (telephoto)
- To zoom out and view a larger area: Move toward **W** (wide-angle)

Zoom out Zoom in

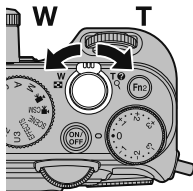

Step 4 *Focus and shoot*

4.1 Press the shutter-release button halfway.

- When the subject is in focus, the focus area that includes the subject or focus indicator glows green (multiple focus areas can glow green).
- When you are using digital zoom, the camera focuses on the subject in the center of the frame and the focus area is not displayed. When the camera has focused, the focus indicator glows green.
- If the focus area or focus indicator flashes red, the camera is unable to focus. Modify the composition and try pressing the shutter-release button halfway again.

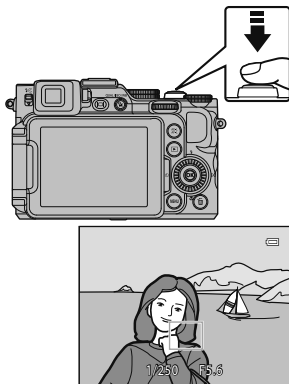

4.2 Without lifting your finger, press the shutter-release button the rest of the way down.

Flash Status Display

When you press the shutter-release button halfway, you can check the flash status by the flash mode icon at the top of the monitor.

- On: The flash fires in accordance with the flash mode when you press the shutter-release button all the way down. When **SAUTO** (auto) is set, the flash fires when  is displayed.
- Flashing: The flash is charging. The camera cannot shoot images.
- Off: The flash does not fire when an image is taken.





Focusing

To set focus and exposure (shutter speed and aperture value), press the shutter-release button halfway.

The focus area varies depending on the shooting mode.

In  (auto) mode, the camera automatically selects one or more of the 9 focus areas containing the subject closest to the camera when the shutter-release button is pressed halfway.



High Temperature Caution

If you are taking images repeatedly with the flash within a short period of time, the flash unit and its surrounding area can become hot. Before lowering the flash, make sure to allow the flash unit and its surrounding area to cool down.



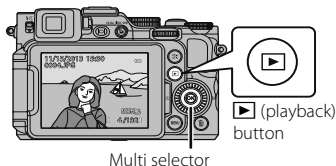

Step 5 *Play Back Images*

5.1 Press the  (playback) button.

- If you press and hold down the  (playback) button while the camera is turned off, the camera turns on in playback mode.



5.2 Use the multi selector to select an image to display.

- Press and hold down    to scroll through the images quickly.
- Images can also be selected by rotating the multi selector or command dial.
- To return to shooting mode, press the  button or shutter-release button.

Display the previous image

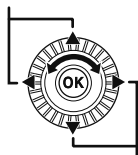

Display the next image







Switching the Information in the Monitor

Press the **Fn2** button to switch between showing and hiding the photo information or shooting information that is displayed in the monitor.

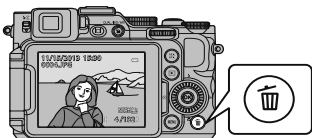
Step 6 Delete an Image

- 6.1** Press the  button to delete the image currently displayed in the monitor.



- 6.2** Use the multi selector   to select **Yes** and press the  button.
- The deleted image cannot be recovered.
 - To cancel, select **No** and press the  button.

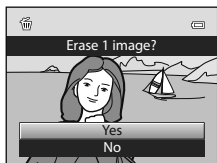

Deleting Multiple Images

To delete multiple images, select **Delete** from the playback menu ( 32).

Step 7 Turn Off the Camera

Press the power switch to turn the camera off.

- When the flash is raised, gently press the flash down to lower it.

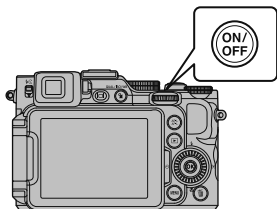

1.1 Start the computer and insert the ViewNX 2 CD-ROM into the CD-ROM drive.

- Windows: If instructions for operating the CD-ROM are displayed in the window, follow the instructions to proceed to the installation window.
- Mac OS: When the **ViewNX 2** window is displayed, double-click the **Welcome** icon.

1.2 Select a language in the language selection dialog to open the installation window.

- If the desired language is not available, click **Region Selection** to choose a different region and then choose the desired language (the **Region Selection** button is not available in the European release).
- Click **Next** to display the installation window.



1.3 Start the installer.

- We recommend clicking **Installation Guide** in the installation window to check the installation help information and system requirements before installing ViewNX 2.
- Click **Typical Installation (Recommended)** in the installation window.
- Follow the on-screen instructions to install the software.

1.4 Exit the installer when the installation completion screen is displayed.

- Windows: Click **Yes**.
- Mac OS: Click **OK**.

The following software is installed:

- ViewNX 2 (consisting of the three modules below)
 - Nikon Transfer 2: For transferring images to the computer
 - ViewNX 2: For viewing, editing, and printing transferred images
 - Nikon Movie Editor: For basic editing of transferred movies
- Panorama Maker (for creating a single panorama photo using a series of images shot in panorama assist scene mode)

1.5 Remove the ViewNX 2 CD-ROM from the CD-ROM drive.

Step 2 *Transferring Images to the Computer*

2.1 Choose how images will be copied to the computer.

Choose one of the following methods:

- **Direct USB connection:** Turn the camera off and ensure that the memory card is inserted in the camera. Connect the camera to the computer using the included USB cable. The camera automatically turns on.

To transfer images that are saved in the camera's internal memory, remove the memory card from the camera before connecting it to the computer.

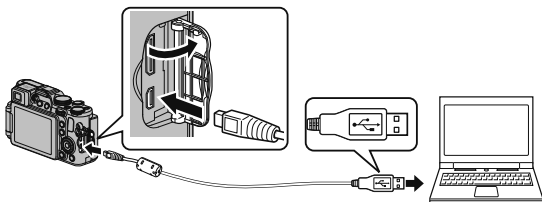

- **SD card slot:** If your computer is equipped with an SD card slot, the card can be inserted directly in the slot.
- **SD card reader:** Connect a card reader (available separately from third-party suppliers) to the computer and insert the memory card.

If a message is displayed prompting you to choose a program, select Nikon Transfer 2.

- **When using Windows 7**

If the dialog shown at right is displayed, follow the steps below to select Nikon Transfer 2.

- 1 Under **Import pictures and videos**, click

Change program. A program selection dialog will be displayed; select **Import File using Nikon Transfer 2** and click **OK**.

- 2 Double-click **Import File**.

If the memory card contains a large number of images, it may take a while for Nikon Transfer 2 to start. Wait until Nikon Transfer 2 starts.



Connecting the USB Cable

The connection may not be recognized if the camera is connected to the computer via a USB hub.

2.2 Transfer images to the computer.

- Confirm that the name of the connected camera or removable disk is displayed as the “Source” on the “Options” title bar of Nikon Transfer 2 (①).
- Click **Start Transfer** (②).

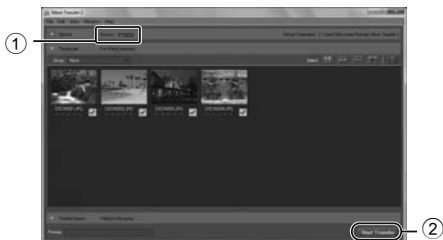

- At default settings, all the images on the memory card will be copied to the computer.
- Images are displayed in ViewNX 2 when transfer is complete.

2.3 Terminate the connection.

- If the camera is connected to the computer, turn the camera off and disconnect the USB cable.
- If you are using a card reader or card slot, choose the appropriate option in the computer operating system to eject the removable disk corresponding to the memory card and then remove the card from the card reader or card slot.



Starting ViewNX 2 Manually

- **Windows:** Double-click the **ViewNX 2** shortcut on the desktop.
- **Mac OS:** Click the **ViewNX 2** icon in the Dock.
- Consult online help for more information on using ViewNX 2.



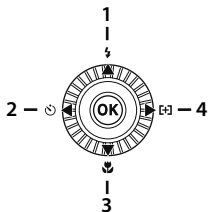

Other Functions

Functions That Can Be Set Using the Multi Selector

Press the multi selector **▲** (⚡), **◀** (⌚), **▼** (👤), or **▶** (⌂) while shooting to operate the following functions.



Function	Description
1 ⚡ Flash mode	The flash modes available are ⚡ AUTO (auto), ⚡👁 (auto with redeye reduction), ⚡ (fill flash), M⚡ (manual), ⚡📺 (slow sync), ⚡🔄 (rearcurtain sync) and ⚡CMD (commander mode) modes. <ul style="list-style-type: none">• ⚡CMD (commander mode) can be used when P, S, A, M, U1, U2 or U3 mode is selected.
Self-timer	The camera is equipped with 10s, 2s, 1s timers.
2 ⌚ Smile timer	The camera detects smiling faces using face priority and releases the shutter automatically.
Remote control	The camera shutter can be released using the Remote Control ML-L3 (available separately from Nikon).

Function	Description
3  Focus mode	<p>Choose from AF (autofocus),  (close range only),  (macro close-up),  (infinity), and MF (manual focus).</p> <ul style="list-style-type: none"> MF can be selected when the shooting mode is P, S, A, M, U1, U2, U3, special effects mode or the Sports scene mode.
4  AF area mode	<p>In shooting modes P, S, A, M, U1, U2, U3 and EFFECTS (special effects), you can change how the camera selects the focus area for autofocus.</p>

Selecting a Shooting Mode

When the mode dial is rotated next to the mark, the camera switches to the corresponding shooting mode shown below.

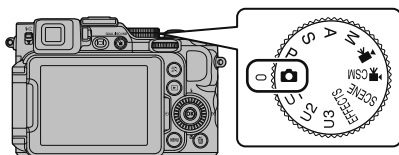

Auto mode

Used for general shooting.

SCENE Scene mode

Camera settings are optimized according to the scene that you select.

When using scene auto selector, the camera automatically selects the optimum scene mode when you frame an image, making it even easier to take images using settings that suit the scene.

EFFECTS Special effects

Effects can be applied to images during shooting.

P, S, A, M mode

Select these modes for greater control over shutter speed and aperture value.

U1, U2, U3 User settings mode

Setting combinations that are frequently used for shooting can be saved. The saved settings can be immediately retrieved for shooting simply by rotating the mode dial to **U1**, **U2** or **U3**.

Movie mode

You can record slow motion and fast motion movies, in addition to basic movies.



CSM Movie custom setting mode

You can use aperture-priority auto or manual mode, or change the settings for image recording.

Basic Quick Menu Operations

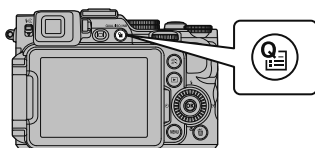

- 1 Press the  button.



- 2 Use the multi selector   to move to the tabs at the top of the screen.



- You can also move to the tabs by rotating the sub-command dial.



- 3 Use   to select the tab for the function to be set.

- You can also select a tab by rotating the main command dial.

- 1 QUAL Image quality/Image size

* **Movie options** will be shown when the mode dial is rotated to  or  CSM.

- 2 ISO ISO sensitivity

- 3 WB White balance

- 4 BKT Auto bracketing

- 5 My My Menu

- 6 PC Picture Control



The functions that can be set vary depending on the shooting mode.

4 Use ▲▼ to select an item and change the setting using ◀▶.

- You can also change the setting by rotating the main command dial.



5 Press the **OK** button or **INFO** button when setting is complete.

- You can also press the shutter-release button to finish setting.

Using Menus (the MENU Button)

Use the multi selector and **OK** button to navigate the menus.

1 Press the **MENU** button.

- The menu that matches the status of the camera, such as shooting or playback menu, is displayed.
Unavailable menu items are displayed in gray and cannot be selected.

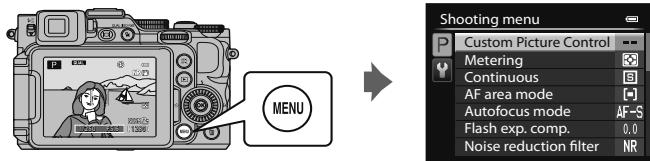

2 Use the multi selector to select a menu item.

- **▲▼** or rotation: Select an item above or below.
- **◀▶**: Select an item on the left or right, or move between menu levels.
- **OK**: Apply a selection. Pressing **▶** also applies a selection.



3 After completing the settings, press the **MENU** button or shutter-release button.

- Press the shutter-release button to display the shooting screen.

Switching Among Menu Tabs

To display a different menu, such as the setup menu, use the multi-selector to switch to another tab.

Tabs

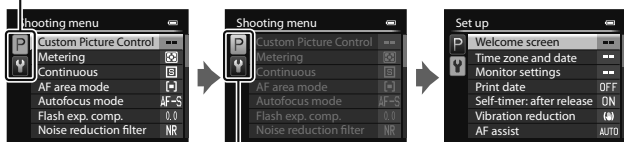

Use ◀ to move to the tabs.



Use ▲▼ to select a tab, and press the **OK** button or ▶ to apply the selection.









Tab Types

For shooting	For playback
<div data-bbox="198 677 295 888"> Shooting P Custom Picture Control Y Metering Continuous AF area mode Autofocus mode AF-S Flash exp. comp. 0.0 Noise reduction filter NR </div> <div data-bbox="326 677 422 888"> User settings U1 Save i Reset P Shoot Y Focal l Photo Virtual Initial </div> <div data-bbox="453 677 550 888"> Set up Y Welcc Time 3 Monit Print o Self-ti Vibrat AF ass </div>	<div data-bbox="797 677 894 888"> Playback ▶ Qu D-L Sk Filt Pri Sli De </div>
<p>P tab: Displays the settings available for the current shooting mode. Depending on the current shooting mode, the tab icon that is displayed will be different. In (auto) mode, only Y tab is displayed.</p> <p>U1/U2/U3 tab: Displays the settings for the specialized menu in U1, U2 or U3 mode.</p> <p>Y tab: Displays the setup menu, where you can change general settings.</p>	<p>▶ tab: Displays the settings available for the playback mode.</p>

Playback Mode

The following options can be performed in full-frame playback mode.

Control	Name	Main Functions
	Zoom control	<ul style="list-style-type: none"> Move toward T (Q) to zoom in on the image, and move toward W (E) to display images as thumbnails or the calendar. Adjust the volume for voice memo and movie playback.
	Multi selector	<ul style="list-style-type: none"> While the playback screen is displayed: Change the displayed image using up (▲), left (◀), down (▼), right (▶), or by rotating the multi selector. While the setting screen is displayed: Select an item using ▲▼◀▶ or by rotating the multi selector. While an enlarged image is displayed: Move the display area.
	OK (apply selection) button	<ul style="list-style-type: none"> Display individual images of a sequence in full-frame playback mode. Scroll an image shot with Easy panorama. Play back movies. Switch from thumbnail playback or zoomed image display to full-frame playback. While the setting screen is displayed, apply the selection.

Control	Name	Main Functions
	Main command dial	<ul style="list-style-type: none"> • Select images and date. • Switch the magnification of an enlarged image.
	Sub-command dial	
	MENU (menu) button	Display and hide the menu.
	 (delete) button	Delete an image.
	Fn2 (function 2) button	Switch the information displayed in the monitor screen.
	 (monitor) button	Switch between the monitor and viewfinder.

For Your Safety

To prevent damage to your Nikon product or injury to yourself or to others, read the following safety precautions in their entirety before using this equipment. Keep these safety instructions where all those who use the product will read them.

The consequences that could result from failure to observe the precautions listed in this section are indicated by the following symbol:



This icon marks warnings, information that should be read before using this Nikon product, to prevent possible injury.

WARNINGS

Turn off in the event of malfunction

Should you notice smoke or an unusual smell coming from the camera or battery charger, unplug the battery charger and remove the battery immediately, taking care to avoid burns. Continued operation could result in injury. After removing or disconnecting the power source, take the equipment to a Nikon-authorized service representative for inspection.

Do not disassemble

Touching the internal parts of the camera or battery charger could result in injury. Repairs should be performed only by qualified technicians. Should the camera or battery charger break open as the result of a fall or other accident, take the product to a Nikon-authorized service representative for inspection, after unplugging the product and/or removing the battery.

Do not use the camera or battery charger in the presence of flammable gas

Do not use electronic equipment in the presence of flammable gas, as this could result in explosion or fire.

 **Handle the camera strap with care**

Never place the strap around the neck of an infant or child.

 **Keep out of reach of children**

Particular care should be taken to prevent infants from putting the battery or other small parts into their mouths.

 **Do not remain in contact with the camera, battery charger, or AC adapter for extended periods while the devices are on or in use**

Parts of the devices become hot. Leaving the devices in direct contact with the skin for extended periods may result in low-temperature burns.

 **Do not leave the product where it will be exposed to extremely high temperatures, such as in an enclosed automobile or in direct sunlight**

Failure to observe this precaution could cause damage or fire.

 **Observe caution when handling the battery**

The battery may leak, overheat, or explode if improperly handled.

Observe the following precautions when handling the battery for use in this product:

- Before replacing the battery, turn the product off. If you are using the battery charger/AC adapter, be sure it is unplugged.
- Use only a Rechargeable Li-ion Battery EN-EL14 (included). Charge the battery by using a Battery Charger MH-24 (included). For Remote Control ML-L3 (available separately), use only 3 V CR2025 lithium battery.
- When inserting the battery, do not attempt to insert it upside down or backwards.
- Do not short or disassemble the battery or attempt to remove or break the battery insulation or casing.
- Do not expose the battery to flame or to excessive heat.
- Do not immerse in or expose to water.

- Replace the terminal cover when transporting the battery. Do not transport or store with metal objects such as necklaces or hairpins.
- The battery is prone to leakage when fully discharged. To avoid damage to the product, be sure to remove the battery when no charge remains.
- Discontinue use immediately should you notice any change in the battery, such as discoloration or deformation.
- If liquid from the damaged battery comes in contact with clothing or skin, rinse immediately with plenty of water.

Observe the following precautions when handling the battery charger

- Keep dry. Failure to observe this precaution could result in fire or electric shock.
- Dust on or near the metal parts of the plug should be removed with a dry cloth. Continued use could result in fire.
- Do not handle the plug or go near the battery charger during lightning storms. Failure to observe this precaution could result in electric shock.
- Do not damage, modify, forcibly tug or bend the USB cable, place it under heavy objects, or expose it to heat or flames. Should the insulation be damaged and the wires become exposed, take it to a Nikon-authorized service representative for inspection. Failure to observe these precautions could result in fire or electric shock.
- Do not handle the plug or battery charger with wet hands. Failure to observe this precaution could result in electric shock.
- Do not use with travel converters or adapters designed to convert from one voltage to another or with DC-to-AC inverters. Failure to observe this precaution could damage the product or cause overheating or fire.

Use appropriate cables

When connecting cables to the input and output jacks, use only the cables provided or sold by Nikon for the purpose, to maintain compliance with product regulations.

 **Handle moving parts with care**

Be careful that your fingers or other objects are not pinched by the lens cover or other moving parts.

 **CD-ROMs**

The CD-ROMs included with this device should not be played back on audio CD equipment. Playing CD-ROMs on an audio CD player could cause hearing loss or damage the equipment.

 **Using the flash close to your subject's eyes could cause temporary visual impairment**

The flash should be no less than 1 m (3 ft 4 in.) from the subject. Particular care should be observed when photographing infants.

 **Do not operate the flash with the flash window touching a person or object**

Failure to observe this precaution could result in burns or fire.

 **Avoid contact with liquid crystal**

Should the monitor break, care should be taken to avoid injury caused by broken glass and to prevent liquid crystal from the monitor touching the skin or entering the eyes or mouth.

 **Turn the power off when using inside an airplane or the hospital**

Turn the power off while inside the aircraft during take off or landing.

Do not use wireless network functions while in the air.

Follow the instructions of the hospital when using while in a hospital.

The electromagnetic waves emitted by this camera may disrupt the electronic systems of the aircraft or the instruments of the hospital.

If you are using wireless network devices, remove them from the camera before boarding an aircraft or entering a hospital.

Notices

Notices for Customers in the U.S.A.

**IMPORTANT SAFETY INSTRUCTIONS -SAVE THESE INSTRUCTIONS.
DANGER - TO REDUCE THE RISK OF FIRE OR ELECTRIC SHOCK,
CAREFULLY FOLLOW THESE INSTRUCTIONS**

For connection to a supply not in the U.S.A., use an attachment plug adapter of the proper configuration for the power outlet if needed. The power supply unit is intended to be correctly orientated in a vertical or floor mount position.

Federal Communications Commission (FCC) Radio Frequency Interference Statement

This equipment has been tested and found to comply with the limits for a Class B digital device, pursuant to Part 15 of the FCC rules. These

limits are designed to provide reasonable protection against harmful interference in a residential installation. This equipment generates, uses, and can radiate radio frequency energy and, if not installed and used in accordance with the instructions, may cause harmful interference to radio communications. However, there is no guarantee that interference will not occur in a particular installation. If this equipment does cause harmful interference to radio or television reception, which can be determined by turning the equipment off and on, the user is encouraged to try to correct the interference by one or more of the following measures:

- Reorient or relocate the receiving antenna.
- Increase the separation between the equipment and receiver.
- Connect the equipment into an outlet on a circuit different from that to which the receiver is connected.



Nikon

COOLPIX P7800

- Consult the dealer or an experienced radio/television technician for help.

CAUTIONS

Modifications

The FCC requires the user to be notified that any changes or modifications made to this device that are not expressly approved by Nikon Corporation may void the user's authority to operate the equipment.

Interface Cables

Use the interface cables sold or provided by Nikon for your equipment. Using other interface cables may exceed the limits of Class B Part 15 of the FCC rules.

Notice for Customers in the State of California

WARNING

Handling the cord on this product will expose you to lead, a chemical known to the State of California to cause birth defects or other reproductive harm.

Wash hands after handling.

Nikon Inc.,
1300 Walt Whitman Road,
Melville, New York 11747-3064
USA
Tel: 631-547-4200

Notice for Customers in Canada

CAN ICES-3 B / NMB-3 B

Caring for the Camera

To ensure continued enjoyment of this Nikon product, observe the precautions described below in addition to the warnings in “For Your Safety” (36-39) when using or storing the device.

Do Not Drop

The product may malfunction if subjected to strong shock or vibration.

Handle the Lens and All Moving Parts with Care

Do not apply force to the lens, lens cover, monitor, memory card slot, or battery chamber. These parts are easily damaged. Applying force to the lens cover could result in camera malfunction or damage to the lens. Should the monitor break, care should be taken to avoid injury caused by broken glass and to prevent the liquid crystal from the display touching the skin or entering the eyes or mouth.

Keep Dry

The device will be damaged if immersed in water or subjected to high humidity.

Avoid Sudden Changes in Temperature

Sudden changes in temperature, such as when entering or leaving a heated building on a cold day, can cause condensation to form inside the device. To prevent condensation, place the device in a carrying case or a plastic bag before exposing it to sudden changes in temperature.

Keep away from Strong Magnetic Fields

Do not use or store this device in the vicinity of equipment that generates strong electromagnetic radiation or magnetic fields. Strong static charge or the magnetic fields produced by equipment such as radio transmitters could interfere with the monitor, damage data saved on the memory card, or affect the product's internal circuitry.

Do Not Point the Lens at Strong Light Sources for Extended Periods

Avoid pointing the lens at the sun or other strong light sources for extended periods when using or storing the camera. Intense light may cause deterioration of the image sensor, producing a white blur effect in photographs.

Turn the Product off Before Removing or Disconnecting the Power Source or the Memory Card

Do not remove the battery while the product is on, or while images are being saved or deleted. Forcibly cutting power in these circumstances could result in loss of data or in damage to product memory or internal circuitry.

Notes About the Monitor

- Monitors and electronic viewfinders are constructed with extremely high precision; at least 99.99% of pixels are effective, with no more than 0.01% being missing or defective. Hence while these displays may contain pixels that are always lit (white, red, blue, or green) or always off (black), this is not a malfunction and has no effect on images recorded with the device.
- Images in the monitor may be difficult to see under bright lighting.
- The monitor is lit by an LED backlight. Should the monitor begin to dim or flicker, contact your Nikon-authorized service representative.

