

D5600

User's Manual (with Warranty)

with **WARRANTY**

D5600 Model Name: N1538

Nikon User Support
Visit the site below to register your camera and keep up-to-date with the latest product information. You will find answers to frequently asked questions (FAQs) and can contact us for technical assistance.
<http://www.europe-nikon.com/support>



Nikon Manual Viewer 2

Install the Nikon Manual Viewer 2 app on your smartphone or tablet to view Nikon digital camera manuals, anytime, anywhere. Nikon Manual Viewer 2 can be downloaded free of charge from the App Store and on Google Play.

About the Reference Manual

For more information on using your Nikon camera, download a pdf copy of the camera Reference Manual from the website listed below.
<http://downloadcenter.nikonimglib.com/>

NIKON CORPORATION
© 2016 Nikon Corporation



AMA16622
Printed in Europe
SBBL04;(11)/6MB37111-04

En

- Read this manual thoroughly before using the camera.
- To ensure proper use of the camera, be sure to read "For Your Safety" (overleaf).
- After reading this manual, keep it in a readily accessible place for future reference.

No reproduction in any form of this manual, in whole or in part (except for brief quotation in critical articles or reviews), may be made without written authorization from NIKON CORPORATION.

Nikon Europe Service Warranty Card

Model name	Serial No.
Nikon D5600	
Purchase date	

■ Name and address of customer

■ Dealer

■ Distributor
Nikon Europe B.V.
Trippolis 100, Burgemeestershuispad 101,
1076 ER Amsterdam, The Netherlands

■ Manufacturer
NIKON CORPORATION
Shinagawa Intercity Tower C, 2-15-3, Konan,
Minato-ku, Tokyo 108-6290 Japan

Warranty Terms - Nikon Europe Service Warranty

Dear Nikon Customer,
We thank you for your purchasing this Nikon product. Should your Nikon product require warranty service, please contact the dealer from whom it was purchased or a member of our authorized service network within the sales territory of Nikon Europe B.V. (e.g. Europe/Russia/others). See details under:
<http://www.europe-nikon.com/support>

In order to avoid any unnecessary inconvenience, we advise you to read the user manuals carefully before contacting the dealer or our authorized service network.

Your Nikon equipment is guaranteed against any manufacturing defects for one full year from the date of original purchase. If during this period of guarantee the product proves defective due to improper material or workmanship, our authorized service network within the sales territory of Nikon Europe B.V. will, without charge for labor and parts, repair the product in the terms and conditions set as below. Nikon reserves the right (at its sole discretion) to replace or repair the product.

1. This warranty is only provided upon presentation of the completed warranty card and original invoice or purchase receipt indicating the date of purchase, product type and dealer's name, together with the product. Nikon reserves the right to refuse free-of-charge warranty service if the above documents cannot be presented or if the information contained in it is incomplete or illegible.

2. This warranty will not cover:
• necessary maintenance and repair or replacement of parts due to normal wear and tear.
• modifications to upgrade the product from its normal purpose as described in user manuals, without the prior written consent of Nikon.
• transport costs and all risks of transport relating directly or indirectly to the warranty of the products.
• any damage resulting from modifications or adjustments which may be made to the product, without the prior written consent of Nikon, in order to comply with local or national technical standards in force in any other country than the ones for which the product was originally designed and/or manufactured.

3. The warranty will not be applicable in the case of:
• damage caused by misuse including but not limited to failure to use the product for its normal purpose or according to the user instructions on the proper use and maintenance, and to installation or use of the product inconsistent with the safety standards in force in the country where it is used.
• damage caused by accidents including but not limited to lightning, water, fire, misuse or neglect.
• defacing, illegibility or removal of the model or serial number on the product.
• damage resulting from repairs or adjustments which have been conducted by unauthorized service organizations or persons.
• defects in any system into which the product is incorporated or with which it is used.

4. This service warranty does not affect the consumer's statutory rights under applicable national laws in force, nor the consumer's right against the dealer arising from their sales/purchase contract.

Notice: An overview of all authorized Nikon Service Stations can be found online by following this Link
(URL = <http://www.europe-nikon.com/service/>).

Package Contents

- D5600 camera
- AN-DC3 strap
- DK-25 rubber eyecup
- User's Manual (this sheet) (comes attached to camera)
- BF-1B body cap
- Warranty (see left)
- EN-EL14a rechargeable Li-ion battery (with terminal cover)
- MH-24 battery charger (plug adapter supplied in countries or regions where required; shape depends on country of sale)

Purchasers of the lens kit option should confirm that the package also includes a lens. *Memory cards are sold separately.* Cameras purchased in Japan display menus and messages in English and Japanese only; other languages are not supported. We apologize for any inconvenience this may cause.

A The Camera Body

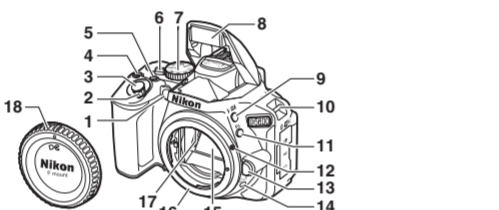

- | | |
|--------------------------|-----------------------------|
| 1 AF-assist illuminator | 9 $\frac{1}{2}$ button |
| 2 Self-timer lamp | 10 Eyelets for camera strap |
| 3 Red-eye reduction lamp | 11 Fn button |
| 4 Power switch | 12 Mounting mark |
| 5 Shutter-release button | 13 Lens release button |
| 6 $\frac{1}{2}$ button | 14 $\frac{1}{2}$ button |
| 7 Movie-record button | 15 Mirror |
| 8 Live view switch | 16 Lens mount |
| 9 Mode dial | 17 CPU contacts |
| 10 Built-in flash | 18 Body cap |

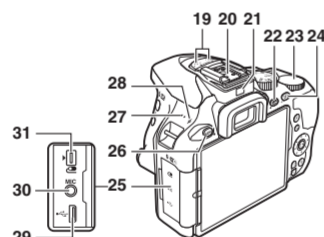

- | | |
|--|--------------------------------------|
| 19 Stereo microphone | 26 MENU button |
| 20 Accessory shoe (for optional flash units) | 27 Speaker |
| 21 Eye sensor | 28 Focal plane mark (→) |
| 22 $\frac{1}{2}$ (information) button | 29 USB connector |
| 23 Command dial | 30 Connector for external microphone |
| 24 $\frac{1}{2}$ button | 31 Accessory terminal |
| 25 Connector cover | |

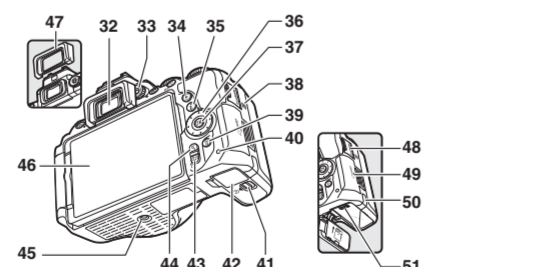

- | | |
|--------------------------------|---|
| 32 Viewfinder eyepiece | 43 $\frac{1}{2}$ button |
| 33 Diopter adjustment control | 44 $\frac{1}{2}$ button |
| 34 $\frac{1}{2}$ button | 45 Tripod socket |
| 35 $\frac{1}{2}$ button | 46 Touch-sensitive vari-angle monitor |
| 36 Multi selector | 47 Rubber eyecup |
| 37 $\frac{1}{2}$ (OK) button | 48 HDMI connector cover |
| 38 N-Mark (NFC antenna) | 49 Memory card slot cover |
| 39 $\frac{1}{2}$ button | 50 Power connector cover for optional power connector |
| 40 Memory card access lamp | 51 Battery latch |
| 41 Battery-chamber cover latch | |
| 42 Battery-chamber cover | |

The Multi Selector

In this manual, operations using the multi selector are represented by $\frac{1}{2}$, $\frac{1}{2}$, $\frac{1}{2}$, and $\frac{1}{2}$ icons.

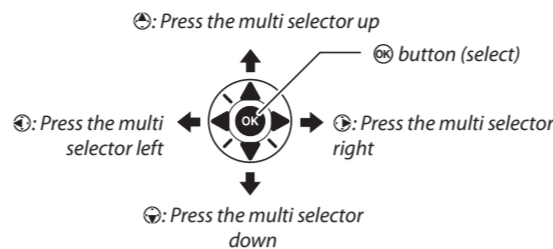

B Quick Start Guide

Attach the Camera Strap

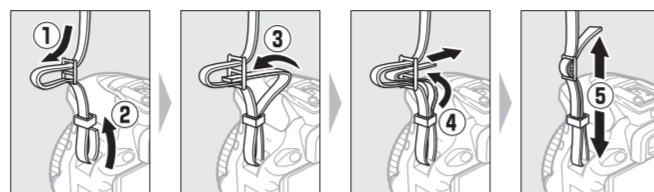

Charge the Battery

If a plug adapter is supplied, raise the wall plug and connect the plug adapter as shown below at left, making sure the plug is fully inserted. Insert the battery and plug the charger in.

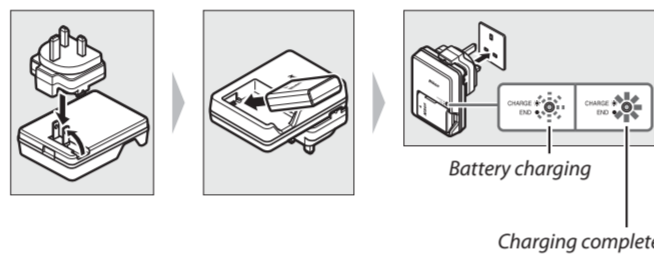

Insert the Battery and a Memory Card

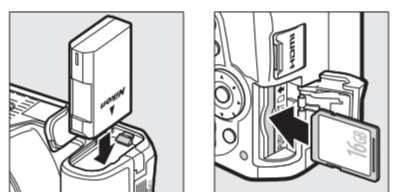

Open the Monitor

Open the monitor as shown. *Do not use force.*

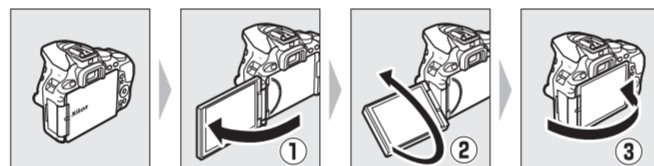

Attach a Lens

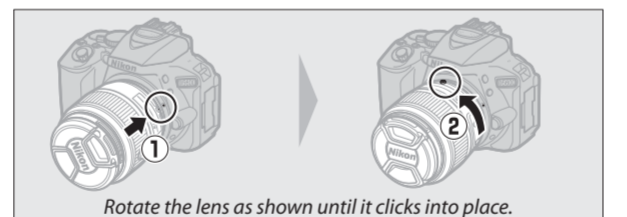
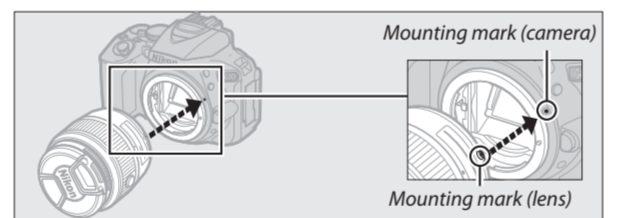

Lenses with Retractable Lens Barrel Buttons

Before using the camera, unlock and extend the lens. Keeping the retractable lens barrel button pressed (1), rotate the zoom ring as shown (2).

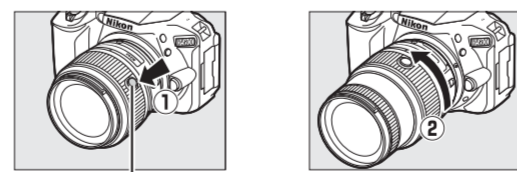

Retractable lens barrel button

Pictures can not be taken when the lens is retracted; if an error message is displayed as a result of the camera having been turned on with the lens retracted, rotate the zoom ring until the message is no longer displayed.



Removing Lenses

To remove the lens, turn the camera off and press and hold the lens-release button on the front of the camera while rotating the lens in the direction opposite that shown above.

Camera Setup

Setup from a Smartphone or Tablet

1 Smart device: Download and install the SnapBridge app.
The app is available free from the Nikon website (<http://snapbridge.nikon.com>), the Apple App Store®, and Google Play™.

2 Camera: Turn the camera on.
A language-selection dialog will be displayed; press $\frac{1}{2}$ and $\frac{1}{2}$ to highlight a language and press $\frac{1}{2}$ to select.

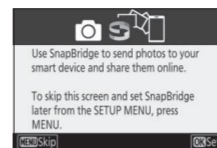
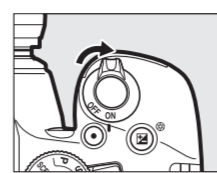

3 Camera: When the dialog at right is displayed, press $\frac{1}{2}$.
If the dialog at right is not displayed or if you wish to configure the camera again, highlight **Connect to smart device** in the setup menu and press $\frac{1}{2}$.

4 Camera/smart device: Start pairing.
• **Android devices with NFC support:** After checking that NFC is enabled on the smart device, touch the camera $\frac{1}{2}$ (N-Mark) to the NFC antenna on the smart device to launch the SnapBridge app, and then follow the on-screen instructions before proceeding to Step 8.
• **iOS devices and Android devices without NFC support:** Press the camera $\frac{1}{2}$ button to ready the camera for pairing.

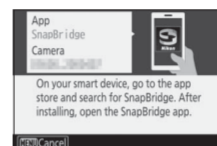

5 Camera: Confirm that the camera displays the message shown at right and ready the smart device.

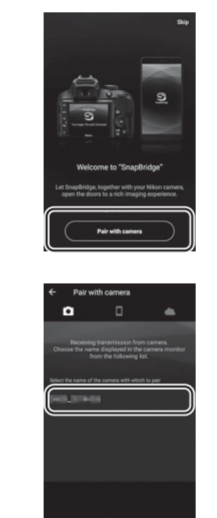

7 Smart device: Tap the camera name in the "Pair with camera" dialog.
Users who are pairing a camera with an iOS device for the first time will first be presented with pairing instructions; after reading the instructions, scroll to the bottom of the display and tap **Understood**. If you are then prompted to choose an accessory, tap the camera name again.

8 Camera/smart device: Confirm that the camera and smart device display the same six-digit number.
Some versions of iOS may not display a number; if no number displayed, proceed to Step 9.

9 Camera/smart device: Press $\frac{1}{2}$ on the camera and tap PAIR on the smart device.

10 Follow the on-screen instructions.
Follow the instructions displayed by the camera and smart device to complete the setup process.

Setup from the Camera Menu

1 Turn the camera on.
A language-selection dialog will be displayed; press $\frac{1}{2}$ and $\frac{1}{2}$ to highlight a language and press $\frac{1}{2}$ to select.

2 Press MENU and set the camera clock.
After setting time zone, date format, and daylight saving time options, use the multi selector and $\frac{1}{2}$ button to set the camera clock.

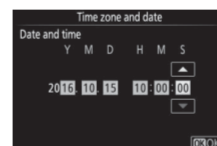

Focus the Viewfinder

After removing the lens cap, rotate the diopter adjustment control until the AF area brackets are in sharp focus. When operating the control with your eye to the viewfinder, be careful not to put your fingers or fingernails in your eye.



Viewfinder not in focus

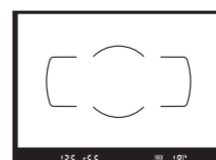

Viewfinder in focus

C "Point-and-Shoot" Modes (AUTO and $\frac{1}{2}$)

1 Rotate the mode dial to $\frac{1}{2}$ or $\frac{1}{2}$.



2 Frame the photograph.



3 Press the shutter-release button halfway to focus.



4 Smoothly press the shutter-release button the rest of the way down to take the photograph.



D Viewing Photographs

Pressing $\frac{1}{2}$ displays a picture in the monitor.

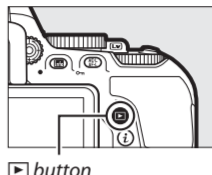

E Deleting Unwanted Photographs

Note that photographs can not be recovered once deleted.

• Press the $\frac{1}{2}$ button. A confirmation dialog will be displayed; press the $\frac{1}{2}$ button again to delete the image and return to playback.

• To exit without deleting the picture, press $\frac{1}{2}$.

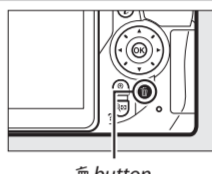

$\frac{1}{2}$ button

F Recording Movies

1 Rotate the live view switch.
The view through the lens will be displayed in the monitor.

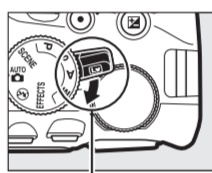

Live view switch

2 Press the shutter-release button halfway to focus.

3 Press the movie-record button to start recording.

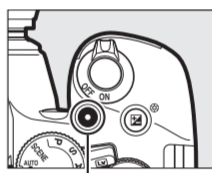

Movie-record button

A recording indicator and the time available are displayed in the monitor.

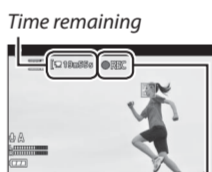

Recording indicator

4 Press the movie-record button again to end recording.

5 Rotate the live view switch to exit live view.

G Camera Menus

Most shooting, playback, and setup options can be accessed from the camera menus. To view the menus, press the MENU button.

Menu options
Options in current menu.

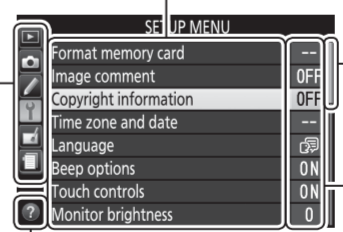

Slider shows position in current menu.

Current settings are shown by icons.

Help icon

If the help icon is displayed, you can press the $\frac{1}{2}$ (?) button to view help for the currently selected item.

Tabs

Choose from the following menus:

- ▶ Playback
- ▶ Shooting
- ▶ Custom Settings
- ▶ Setup
- ▶ Retouch
- ▶ Recent Settings / My Menu

Caring for the Camera

Storage

When the camera will not be used for an extended period, turn the camera off and remove the battery. Do not store in locations that:
• are poorly ventilated or subject to humidities of over 60%
• are next to equipment that produces strong electromagnetic fields, such as televisions or radios
• are exposed to temperatures above 50 °C (122 °F) or below -10 °C (14 °F)

Cleaning

Camera Body

Use a blower to remove dust and lint, then wipe gently with a soft, dry cloth. After using the camera at the beach or seaside, wipe off sand or salt with a cloth lightly dampened in distilled water and dry thoroughly. **Important:** Dust or other foreign matter inside the camera may cause damage not covered under warranty.

Lens, Mirror, and Viewfinder

These glass elements are easily damaged. Remove dust and lint with a blower. If using an aerosol blower, keep the can vertical to prevent the discharge of liquid. To remove fingerprints and other stains, apply a small amount of lens cleaner to a soft cloth and clean with care.

Monitor

Remove dust and lint with a soft cloth. When removing fingerprints and other stains, wipe the surface lightly with a soft cloth or chamois leather. Do not apply pressure, as this could result in damage or malfunction.

* Do not use alcohol, thinner, or other volatile chemicals.

Troubleshooting

Battery/Display

The camera is on but does not respond. Wait for recording to end. If the problem persists, turn the camera off. If the camera does not turn off, remove and reinsert the battery or, if you are using an AC adapter, disconnect and reconnect the AC adapter. Note that although any data currently being recorded will be lost, data that have already been recorded will not be affected by removing or disconnecting the power source.

Viewfinder is dark: Insert a fully-charged battery.

Displays turn off without warning: Choose longer delays for Custom Setting c2 (Auto off timers).

Viewfinder display is unresponsive and dim: The response times and brightness of this display vary with temperature.

Fine lines are visible around active focus point or display turns red when focus point is highlighted: These phenomena are normal for this type of viewfinder and do not indicate a malfunction.

Shooting (All Modes)

Camera takes time to turn on: Delete files or folders.

Specifications

Nikon D5600 Digital Camera

Type	Single-lens reflex digital camera
Lens mount	Nikon F mount (with AF contacts)
Effective angle of view	Nikon DX format; focal length equivalent to approx. 1.5x that of lenses with FX format angle of view

Effective pixels	
Effective pixels	24.2 million

Image sensor	
Image sensor	23.5 × 15.6 mm CMOS sensor
Total pixels	24.78 million
Dust-reduction System	Image sensor cleaning, Image Dust Off reference data (Capture NX-D software required)

Storage	
Image size (pixels)	• 6000 × 4000 (Large) • 4496 × 3000 (Medium) • 2992 × 2000 (Small)

File format	• NEF (RAW): 12- or 14 bit, compressed • JPEG: JPEG-Baseline compliant with fine (approx. 1 : 4), normal (approx. 1 : 8), or basic (approx. 1 : 16) compression • NEF (RAW)+JPEG: Single photograph recorded in both NEF (RAW) and JPEG formats
-------------	--

Picture Control System	Standard, Neutral, Vivid, Monochrome, Portrait, Landscape, Flat; selected Picture Control can be modified; storage for custom Picture Controls
------------------------	--

Media	SD (Secure Digital) and UHS-I compliant SDHC and SDXC memory cards
-------	--

File system	DCF 2.0, Exif 2.3, PictBridge
-------------	-------------------------------

Viewfinder	Eye-level pentamirror single-lens reflex viewfinder
Viewfinder	Eye-level pentamirror single-lens reflex viewfinder
Frame coverage	Approx. 95% horizontal and 95% vertical
Magnification	Approx. 0.82x (50 mm f/1.4 lens at infinity, -1.0 m ⁻¹)
Eyepoint	17 mm (-1.0 m ⁻¹); from center surface of viewfinder eyepiece lens
Diopter adjustment	-1.7→+0.5 m ⁻¹
Focusing screen	Type B BriteView Clear Matte Mark VII screen
Reflex mirror	Quick return
Lens aperture	Instant return, electronically controlled

Lens	
Autofocus support	Autofocus is available with AF-S, AF-P, and AF-I lenses.

Shutter	
Type	Electronically-controlled vertical-travel focal-plane shutter

Speed	1/4000-30 s in steps of 1/5 or 1/2 EV; Bulb; Time
Flash sync speed	X = 1/200 s; synchronizes with shutter at 1/200 s or slower

