

Nikon

Wireless Remote Controller

WR-R11a

WR-R11b

WR-T10

Reference Manual

- Read this manual thoroughly before using the product.
- To ensure proper use of the product, be sure to read "For Your Safety" (page ix).
- After reading this manual, keep it in a readily accessible place for future reference.

En

What the WR-R11a/WR-R11b Can Do for You

The WR-R11a/WR-R11b can be used in combination with other devices to control cameras or flash units. It can also be used to release the shutters on multiple cameras simultaneously.

■ Remote Release with the WR-T10

A WR-T10 wireless transmitter can be used to release the shutter on a camera to which a WR-R11a/WR-R11b is attached (📖 8).

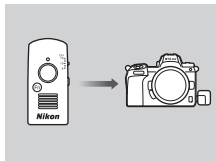

■ Simultaneous Release with the WR-T10

Attach WR-R11a/WR-R11b units to multiple cameras and press the shutter-release button on the WR-T10 to release the shutters simultaneously on all cameras (📖 11).

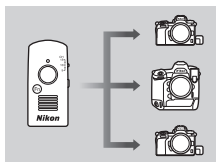

WR-R11a Model Name: N2012

WR-R11b Model Name: N1839

■ ■ Synchronized Release with the WR-R11a/ WR-R11b

Attach WR-R11a/WR-R11b units to multiple cameras for synchronized shutter release controlled by a single camera (📖 13).

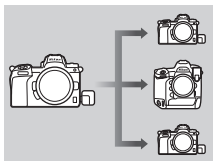

■ ■ Using the WR-R11a/WR-R11b with WR-1 Wireless Remote Controllers

In combination with a WR-1 wireless remote controller, the WR-R11a/WR-R11b can be used for interval-timer photography—in which the camera takes a selected number of shots automatically at preset intervals—and long time-exposures, as well as for simultaneous and synchronized release (📖 18).

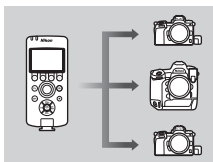

■ Using the WR-R11a/WR-R11b with SB-5000 Flash Units

Control flash units remotely via radio (radio AWL). Flash settings for the SB-5000, including flash control mode and flash output, can be adjusted from the camera (📖 24).

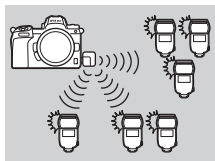

■ Controlling Devices on Different Channels

The WR-R11a/WR-R11b supports three channels: 5, 10, and 15. Devices connected via different channels can be controlled separately simply by switching the channel (📖 34).

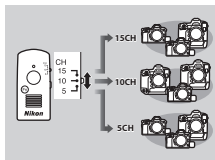

Supplied Accessories

This manual assumes that your WR-R11a or WR-R11b comes bundled as a kit with the purchase of a WR-T10. Depending on whether it is part of a kit, the accessories supplied will vary. Contact your retailer should you notice anything missing.

Purchase includes	Supplied accessories
A WR-R11a and WR-T10	<input type="checkbox"/> Strap for WR-R11a or WR-R11b <input type="checkbox"/> Strap for WR-T10 <input type="checkbox"/> CR2032 3 V lithium battery *
A WR-R11b and WR-T10	<input type="checkbox"/> Case <input type="checkbox"/> <i>User's Manual</i> <input type="checkbox"/> Warranty
A WR-R11a	<input type="checkbox"/> Strap for WR-R11a or WR-R11b <input type="checkbox"/> Case
A WR-R11b	<input type="checkbox"/> <i>User's Manual</i> <input type="checkbox"/> Warranty

* Remove the insulating sheet from the WR-T10 before first use.



About This Manual

A WR-T10 transmitter can be used for wireless remote control of a compatible Nikon camera to which a WR-R11a/WR-R11b transceiver has been attached. The WR-R11a/WR-R11b can also be used in combination with a WR-1 wireless remote controller or for radio control of SB-5000 flash units. Before using this product, please read this *Reference Manual* carefully. You will also need to consult the camera manual.

The WR-R11a is for use with cameras with a ten-pin remote terminal, the WR-R11b for use with cameras with an accessory terminal.

■ Symbols

The following symbols are employed in this manual. Use them to help locate the information you need.

	This icon marks notes, information that should be read before using this product.
	This icon marks tips, additional information you may find helpful when using this product.
	This icon marks references to other sections in this manual.

For Your Safety

“For Your Safety” contains important safety instructions. Be sure to read them before using the product. For more information, see “For Your Safety” ( ix).

Table of Contents

What the WR-R11a/WR-R11b Can Do for You	ii
Supplied Accessories	v
About This Manual.....	vi
For Your Safety.....	ix
Wireless Regulation Data.....	xiii
Notices.....	xvi

Getting Started **1**

Parts of the Controller	1
WR-R11a.....	1
WR-R11b	1
WR-T10	2
Attaching the WR-R11a/WR-R11b (Transceiver)	5
Attaching the WR-R11a	5
Attaching the WR-R11b.....	6
Using the WR-R11a/WR-R11b with the WR-T10: The Basics	8
Pairing the WR-R11a/WR-R11b and WR-T10	8
Taking Pictures	10

Advanced Use **11**

Applications for the WR-R11a/WR-R11b and WR-T10	11
Simultaneous Release with the WR-T10	11
Synchronized Release with the WR-R11a/ WR-R11b.....	13
Using the WR-R11a/WR-R11b with Other Devices.....	18
Using the WR-R11a/WR-R11b with WR-1 Wireless Remote Controllers	18
Using the WR-R11a/WR-R11b with SB-5000 Flash Units	24
Channel Selection	34

Technical Notes **35**

Status LEDs	35
WR-R11a/WR-R11b	35
WR-T10	39
Specifications.....	40
WR-R11a/WR-R11b Wireless Remote Controller.....	40
WR-T10 Wireless Remote Controller	41

For Your Safety

To prevent damage to property or injury to yourself or to others, read “For Your Safety” in its entirety before using this product.

Keep these safety instructions where all those who use this product will read them.

⚠ DANGER: Failure to observe the precautions marked with this icon carries a high risk of death or severe injury.

⚠ WARNING: Failure to observe the precautions marked with this icon could result in death or severe injury.

⚠ CAUTION: Failure to observe the precautions marked with this icon could result in injury or property damage.

⚠ WARNING

Do not use while walking or operating a vehicle.

Failure to observe this precaution could result in accidents or other injury.

Do not disassemble or modify this product.

Do not touch internal parts that become exposed as the result of a fall or other accident.

Failure to observe these precautions could result in electric shock or other injury.

Should you notice any abnormalities such as the product producing smoke, heat, or unusual odors, immediately disconnect the batteries or power source.

Continued operation could result in fire, burns or other injury.

Keep dry.

Do not handle with wet hands.

Failure to observe these precautions could result in fire or electric shock.

Do not use this product in the presence of flammable dust or gas such as propane, gasoline or aerosols.

Failure to observe this precaution could result in explosion or fire.

Keep this product out of reach of children.

Failure to observe this precaution could result in injury or product malfunction.

In addition, note that small parts constitute a choking hazard.

Should a child swallow any part of this product, seek immediate medical attention.

Do not entangle, wrap or twist the straps around your neck.

Failure to observe this precaution could result in accidents.

Do not use batteries not specifically designated for use with this product.

Failure to observe this precaution could result in fire or electric shock.

CAUTION

Turn this product off when its use is prohibited.

Disable wireless features when the use of wireless equipment is prohibited.

The radio-frequency emissions produced by this product could interfere with equipment onboard aircraft or in hospitals or other medical facilities.

Remove the battery if this product will not be used for an extended period.

Failure to observe this precaution could result in fire or product malfunction.

Do not leave the product where it will be exposed to extremely high temperatures, for an extended period such as in an enclosed automobile or in direct sunlight.

Failure to observe this precaution could result in fire or product malfunction.

 **DANGER (Batteries)**

Do not mishandle batteries.

Failure to observe the following precautions could result in the battery leaking, overheating, rupturing, or catching fire:

- Do not attempt to recharge the battery.
 - Do not expose batteries to flame or excessive heat.
 - Do not disassemble.
 - Do not short-circuit the terminals by touching them to necklaces, hairpins, or other metal objects.
 - Do not expose batteries or the products in which they are inserted to powerful physical shocks.
-

Do not ingest batteries.

Chemical burn hazard.

This product includes one or more lithium coin/button cell batteries. Swallowing lithium coin/button cell batteries can cause severe internal burns in just 2 hours and can lead to death.

Keep new and used batteries away from children.

If the battery compartment does not close securely, stop using the product and keep it out of reach of children.

If you think batteries may have been swallowed or placed anywhere inside the body, seek immediate medical attention.

If battery liquid comes into contact with the eyes, rinse with plenty of clean water and seek immediate medical attention.

Delaying action could result in eye injuries.

Follow the instructions of airline personnel.

Batteries left unattended at high altitudes in an unpressurized environment may leak, overheat, rupture, or catch fire.

WARNING (Batteries)

Keep batteries out of reach of children.

Should a child swallow a battery, seek immediate medical attention.

Do not immerse batteries in water or expose to rain.

Failure to observe this precaution could result in fire or product malfunction. Immediately dry the product with a towel or similar object should it become wet.

Discontinue use immediately should you notice any changes in the battery, such as discoloration or deformation.

Failure to observe this precaution could result in the battery leaking, overheating, rupturing, or catching fire.

Insert the battery in the correct orientation.

Failure to observe this precaution could result in the battery leaking, overheating, rupturing, or catching fire.

When batteries are no longer needed, insulate the terminals with tape.

Overheating, rupture, or fire may result should metal objects come into contact with the terminals.

If battery liquid comes into contact with a person's skin or clothing, immediately rinse the affected area with plenty of clean water.

Failure to observe this precaution could result in skin irritation.

Wireless Regulation Data

The use of wireless devices may be prohibited in some countries or regions. Contact a Nikon-authorized service representative before using the wireless features of this product outside the country of purchase.

● Notice for Customers in the U.S.A. and Canada

This device complies with part 15 of FCC Rules and Innovation, Science and Economic Development Canada's licence-exempt RSSs. Operation is subject to the following two conditions: (1) this device may not cause harmful interference, and (2) this device must accept any interference received, including interference that may cause undesired operation.

FCC WARNING

The FCC requires the user to be notified that any changes or modifications made to this device that are not expressly approved by Nikon Corporation may void the user's authority to operate the equipment.

FCC Radio Frequency Interference Statement

Note: This equipment has been tested and found to comply with the limits for a Class B digital device, pursuant to part 15 of the FCC Rules. These limits are designed to provide reasonable protection against harmful interference in a residential installation. This equipment generates, uses and can radiate radio frequency energy and, if not installed and used in accordance with the instructions, may cause harmful interference to radio communications. However, there is no guarantee that interference will not occur in a particular installation. If this equipment does cause harmful interference to radio or television reception, which can be determined by turning the equipment off and on, the user is encouraged to try to correct the interference by one or more of the following measures:

- Reorient or relocate the receiving antenna.
- Increase the separation between the equipment and receiver.
- Connect the equipment into an outlet on a circuit different from that to which the receiver is connected.
- Consult the dealer or an experienced radio/ TV technician for help.

Co-location

This transmitter must not be co-located or operated in conjunction with any other antenna or transmitter.

Nikon Inc., 1300 Walt Whitman Road, Melville, New York 11747-3064, U.S.A.

Tel.: 631-547-4200

FCC/ISED RF Exposure Statement

The available scientific evidence does not show that any health problems are associated with using low power wireless devices. There is no proof, however, that these low power wireless devices are absolutely safe. Low power Wireless devices emit low levels of radio frequency energy (RF) in the microwave range while being used. Whereas high levels of RF can produce health effects (by heating tissue), exposure of low-level RF that does not produce heating effects causes no known adverse health effects. Many studies of low-level RF exposures have not found any biological effects. Some studies have suggested that some biological effects might occur, but such findings have not been confirmed by additional research. This product has been tested and found to comply with FCC/ISED radiation exposure limits set forth for an uncontrolled environment and meets the FCC radio frequency (RF) Exposure Guidelines and RSS-102 of the ISED radio frequency (RF) Exposure rules. Please refer to the SAR test report that was uploaded to FCC website.

● Notice for Customers in Europe and in Countries Complying with the Radio Equipment Directive

Hereby, Nikon Corporation declares that the radio equipment types WR-T10, WR-R11a, and WR-R11b are in compliance with Directive 2014/53/EU.



The full texts of the EU declarations of conformity are available at the following internet addresses:

- **WR-T10:** https://imaging.nikon.com/support/pdf/DoC_WR-T10.pdf
- **WR-R11a:** https://imaging.nikon.com/support/pdf/DoC_N2012.pdf
- **WR-R11b:** https://imaging.nikon.com/support/pdf/DoC_N1839.pdf

● Notice for Customers in Singapore

Complies with
IMDA Standards
DA103423

● Notice for Customers in Malaysia



● Notice for Customers in Australia and New Zealand

This device complies with radio-frequency regulations. The content of certification labels not affixed to the device is given below.



Notices

● About This Manual

- In the absence of prior permission, reproduction or distribution of the *User's Manual*, *Reference Manual*, or online manuals for this product, whether in whole or in part, is strictly prohibited.
- Nikon reserves the right to change the appearance, specifications, and performance of the product described in this manual without prior notice.
- Nikon will not be held liable for damages that may result from any mistakes that this manual may contain.

● Export

This product is controlled by the United States Export Administration Regulations (EAR). The permission of the United States government is not required for export to countries other than the following, which as of this writing are subject to embargo or special controls: Cuba, Iran, North Korea, Sudan, and Syria (list subject to change).

● Notice for Customers in Canada

CAN ICES-3 B / NMB-3 B

● Notices for Customers in Europe

This symbol indicates that electrical and electronic equipment is to be collected separately.

The following apply only to users in European countries:

- This product is designated for separate collection at an appropriate collection point. Do not dispose of as household waste.
- Separate collection and recycling helps conserve natural resources and prevent negative consequences for human health and the environment that might result from incorrect disposal.
- For more information, contact the retailer or the local authorities in charge of waste management.



Getting Started

Parts of the Controller

WR-R11a

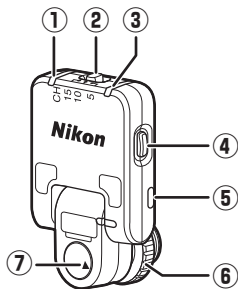

- 1 Red LED
- 2 Channel selector
- 3 Green LED
- 4 Pairing button
- 5 Strap eyelet
- 6 Locking screw
- 7 Mounting mark (▽)

WR-R11b

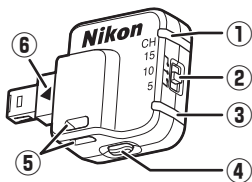

- 1 Red LED
- 2 Channel selector
- 3 Green LED
- 4 Pairing button
- 5 Strap eyelet
- 6 Mounting mark (▽)

WR-T10

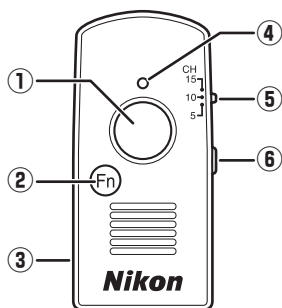

- 1 Shutter-release button
- 2 **Fn** button
- 3 Strap eyelet
- 4 Red LED
- 5 Channel selector
- 6 Pairing button

Straps for the WR-R11a and WR-R11b

Attach the controller to the camera strap as shown to prevent it being lost or dropped.

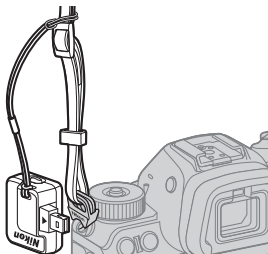

The WR-T10 Fn Button

The function performed by pressing the **Fn** button on the WR-T10 is assigned by the camera. Its role varies depending on the camera to which the WR-R11a/WR-R11b is attached.

- In the case of cameras with menu items controlling the behavior of **Fn** buttons on remote controllers ([**Assign remote (WR) Fn button**], [**Assign remote Fn button**], [**Accessory terminal**], or [**Remote control**]), it performs the role assigned in the menus. The name of the relevant menu item and its location vary with the camera.
 - If you are using a D4, D800, or D800E, be sure the camera firmware is up-to-date.
- In the case of the D7100, D5300, and D5200, it performs the same role as the camera **Fn** button.
- With all other cameras, it activates the standby timer.

✔ Replacing CR2032 3 V Lithium Batteries

Replace the battery when the LED for the WR-T10 starts to dim. Insert a fingernail behind the battery-chamber latch and open the battery chamber (①). Ensure that the battery is inserted in the correct orientation (③).

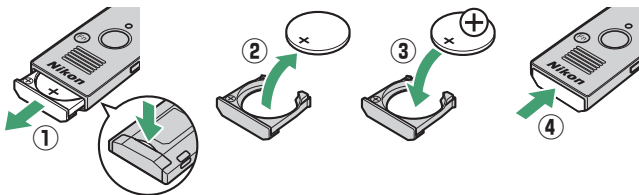

Attaching the WR-R11a/WR-R11b (Transceiver)

To use the WR-R11a/WR-R11b, attach it to a compatible camera.

✔ Before Attaching the WR-R11a/WR-R11b

- Be sure the camera is off before proceeding.
- For information on cameras that can be used with the WR-R11a/WR-R11b, see “Specifications” under “supported cameras” (p. 40).

Attaching the WR-R11a

Connect the WR-R11a to the camera's 10-pin remote terminal (①) as shown by the mounting marks on the WR-R11a (▽) and camera (●) and tighten the WR-R11a locking screw (②).

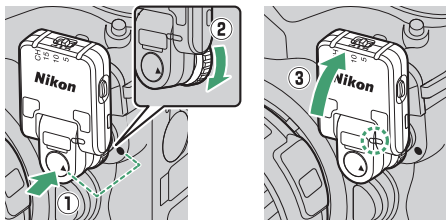

✔ Aligning the Mounting Marks

After attaching the controller, angle it so that the mounting marks align as shown (③). Failure to observe this precaution could cause damage or product malfunction.

Attaching the WR-R11b

Connect the WR-R11b to the camera's accessory terminal as shown by the mounting marks on the WR-R11b (▽) and camera (▲).

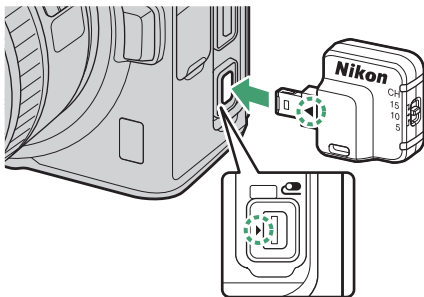

Attaching the WR-R11a/WR-R11b

- When attaching the WR-R11a/WR-R11b, be sure the connectors match and are in the correct orientation; do not use force or insert the connectors at an angle. Inserting the connectors in the wrong orientation could damage the product.
- To prevent unintended camera operation, be sure the WR-R11a/WR-R11b is properly connected.
- The WR-R11a/WR-R11b cannot be used with certain accessories. Forcibly attempting to use the controller together with an incompatible accessory could result in damage to, or malfunction of, the accessory or camera.
- With some film cameras, it may be necessary to rotate the WR-R11a to align the mounting marks.

Removing the WR-R11a/WR-R11b

- The WR-R11a/WR-R11b can be removed from the camera by performing the steps to attach it in reverse order.
 - Remove the WR-R11a/WR-R11b from the camera when it is not in use. Leaving it in place while transporting the camera either in a bag or suspended from a strap could result in damage to the camera or controller in the event that they are subject to excessive force or vibration.
-

Using the WR-R11a/WR-R11b with the WR-T10: The Basics

After attaching the WR-R11a/WR-R11b to the camera, you are ready first to pair it with the WR-T10 and then use the WR-T10 to take pictures remotely.

Pairing the WR-R11a/WR-R11b and WR-T10

✓ At Shipment

The WR-R11a/WR-R11b and WR-T10 are not paired at shipment.

1 Turn on the camera to which the WR-R11a/WR-R11b is attached.

2 Set the WR-R11a/WR-R11b and WR-T10 to the same channel.

Set the channel selectors on the WR-R11a/WR-R11b and WR-T10 to the same channel (5, 10, or 15).

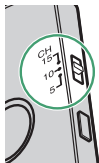
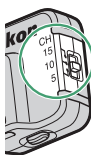

3 Pair the devices.

- Press the pairing buttons on the WR-R11a/WR-R11b and WR-T10 simultaneously. Pairing is complete when the red and green LEDs on the WR-R11a/WR-R11b flash on and off in sequence.
- When pairing devices, place them close together.

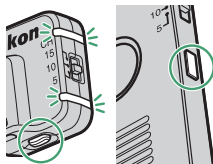

Pairing Failure

If the red and green LEDs do not flash on and off in sequence, pairing has failed. Release the pairing buttons on the WR-R11a/WR-R11b and WR-T10 and repeat Step 3.

Channel Selection

- Devices that are not on the same channel cannot be paired.
- Changing the channel on either device once pairing is complete will interrupt the connection. The connection will resume when the devices are again set to the same channel; the pairing process need not be repeated.

Ending Pairing

Press the pairing button on the WR-R11a/WR-R11b; the green LED will start to flash rapidly (about 5 times a second). Keep the button pressed for about 3 seconds longer and the green LED will start to flicker (about 20 times a second). While the green LED is still flickering, press the pairing button on the WR-R11a/WR-R11b twice in quick succession (within about a second). The green and red LEDs will flash twice simultaneously to show that pairing has ended and all pairing data have been erased.

- If pairing fails to end, the red LED will not light. In this case, end pairing by repeating the procedure above.
-

Taking Pictures

After pairing the devices, you can use the shutter-release button on the WR-T10 to release the shutter on the camera to which the WR-R11a/WR-R11b is attached. The shutter-release button on the WR-T10 performs the same functions as the camera shutter-release button whether pressed halfway or all the way down.

1 Frame the shot on the camera to which the WR-R11a/WR-R11b is attached.

Use of a tripod is recommended.

2 Press the WR-T10 shutter-release button halfway to focus.

3 Press the WR-T10 shutter-release button the rest of the way down to shoot.

Advanced Use

Applications for the WR-R11a/WR-R11b and WR-T10

The WR-T10 can be used to simultaneously release the shutters on all cameras to which WR-R11a/WR-R11b controllers have been attached.

Simultaneous Release with the WR-T10

A single WR-T10 can be paired with multiple WR-R11a/WR-R11b controllers and used to simultaneously release the shutters on multiple cameras with one press of the WR-T10's shutter-release button.

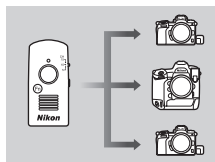

1 Pair the WR-T10 with each WR-R11a/WR-R11b controller.

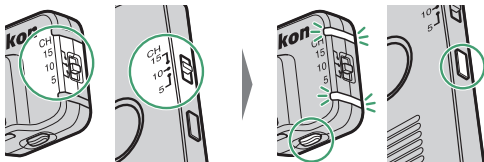

- Pair the WR-T10 with each WR-R11a/WR-R11b controller. For more information, see “Using the WR-R11a/WR-R11b with the WR-T10: The Basics” (8).
- Set all WR-R11a/WR-R11b controllers to the same channel.
- Here, all controllers are set to Channel 10.
- Pairing is also available with WR-R10 controllers. Simultaneous release with a mix of WR-R11a/WR-R11b and WR-R10 controllers is also supported.

2 Take pictures.

Pressing the shutter-release button on the WR-T10 releases the shutters on all cameras to which paired WR-R11a/WR-R11b controllers are attached.

Synchronized Release with the WR-R11a/ WR-R11b

Wireless connections can be established between WR-R11a/WR-R11b controllers mounted on multiple cameras. Releasing the shutter on any of the cameras to which the interconnected WR-R11a/WR-R11b controllers is attached

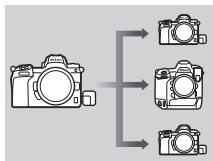

synchronously releases the shutters on the remaining cameras. Wireless connections can be established between WR-R11a/WR-R11b controllers via pairing or using a PIN.

Method	Description
Pairing	Simply press the pairing buttons on two controllers simultaneously to establish a connection (☐ 14). No complicated settings are required.
PIN	Connections can be established between controllers with identical four-digit PINs (☐ 16). Connections will automatically be established between devices with the same PIN, making this a good choice for photography featuring a large number of remote devices.

Master and Remote

- The camera that transmits a release signal when the shutter-release button is pressed is referred to as the “master” camera, while the cameras that release their shutters in response are referred to as “remote” cameras.
- The cameras that can function in the role of master are the D780, mirrorless cameras, and cameras compatible with the WR-R11a. Other cameras can serve as remote cameras.

■ Pairing

Press the pairing buttons on the WR-R11a/WR-R11b controllers simultaneously, just as you would when pairing the devices with a WR-T10.

1 Turn on the cameras to which the WR-R11a/WR-R11b controllers are attached.

2 Set the WR-R11a/WR-R11b controllers to the same channel.

- Set the channel selectors on the WR-R11a/WR-R11b controllers to the same channel (5, 10, or 15).
- Here, all controllers are set to Channel 10.

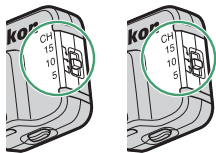

3 Pair the devices.

- Press the pairing buttons on both WR-R11a/WR-R11b controllers simultaneously. Pairing is complete when the red and green LEDs on the controllers flash on and off in sequence.
- When pairing devices, place them close together.
- To synchronize release with further cameras, pair the master with the WR-R11a/WR-R11b for each of the remote cameras.
- Pairing is also available with WR-R10 controllers. Synchronized release with a mix of WR-R11a/WR-R11b and WR-R10 controllers is also supported.

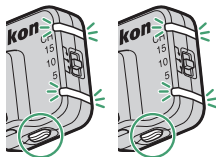

4 Take pictures.

Releasing the shutter on the master camera releases the shutters on all cameras to which paired WR-R11a/WR-R11b controllers are attached.

■ PIN

Connections can be established between controllers with identical four-digit PINs. Any four-digit PIN can be used.

- PIN connections are available only with cameras that offer **[Wireless remote (WR) options]** in the setup menu. Use pairing to connect to other cameras.
- Pairing is not required for wireless PIN connections.

1 Turn on the cameras to which the WR-R11a/WR-R11b controllers are attached.

2 Set the WR-R11a/WR-R11b controllers to the same channel.

- Set the channel selectors on the WR-R11a/WR-R11b controllers to the same channel (5, 10, or 15).
- Here, all controllers are set to Channel 10.

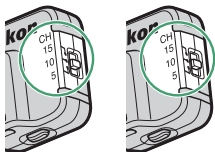



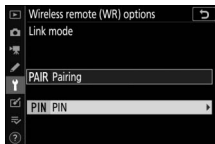

3 On the master camera, select **[Wireless remote (WR) options]** > **[Link mode]** in the setup menu, then highlight **[PIN]** and press **OK**.

A PIN-entry dialog will be displayed.



4 Enter a PIN.

Using the  and  buttons on the multi selector to highlight digits and  and  to change, edit the PIN and then press .



5 Enter the PINs for the WR-R11a/WR-R11b controllers on the remote cameras.

- In the setup menu, select [**Wireless remote (WR) options**] > [**Link mode**] > [**PIN**] and enter the PIN code selected in Step 4.
- A connection will be established automatically when you press .
- To synchronize release with further cameras, enter the PIN code on each device to which a WR-R11a/WR-R11b is attached.



6 Take pictures.

Releasing the shutter on the master camera releases the shutters on all cameras with WR-R11a/WR-R11b controllers connected via PIN.

Using the WR-R11a/WR-R11b with Other Devices

WR-R11a/WR-R11b controllers can be used with WR-1 wireless remote controllers and SB-5000 flash units.

Using the WR-R11a/WR-R11b with WR-1 Wireless Remote Controllers

In combination with a WR-1 wireless remote controller, the WR-R11a/WR-R11b can be used for interval-timer photography—in which the camera automatically takes pictures automatically at preset intervals—and long time-exposures, as well as for simultaneous and synchronized release.

- For more information, see the documentation for the WR-1.
- When reading the documentation for the WR-1, replace all references to the WR-R10 with the WR-R11a/WR-R11b.
- When used as a transmitter, the WR-1 should be placed in Group A.
- The WR-R11a/WR-R11b must be paired with the WR-1 (📖 21).

■ Features Available with the WR-1

● Simultaneous Release

A single WR-1 can be paired with multiple WR-R11a/WR-R11b controllers and used to simultaneously release the shutters on multiple cameras with one press of the WR-1's shutter-release button (☐ 11).

● Synchronized Release

When attached to multiple cameras, WR-1 or WR-R11a/WR-R11b controllers can be used for synchronized release between a master camera and one or more remote cameras (☐ 13).

● Remote Fn Button

The **Fn** button on a transmitting WR-1 performs the function assigned by cameras to which the WR-R11a/WR-R11b controllers are attached.

- The **Fn** button functions in the same way as the button on the WR-T10 (☐ 3).
- This feature is available only when the WR-1 functions independently as a transmitter. It is not available when the WR-1 is mounted on a camera.

● Interval-Timer Photography

The WR-1 can be used for interval-timer photography, in which the camera automatically takes a selected number of shots automatically at preset intervals.

- This feature is available only when the WR-1 functions independently as a transmitter.

● **Release Hold Time**

Choose the time the shutter-release button remains in the fully-pressed state for long time-exposures or to take single shots in burst release modes.

- This feature is available only when the WR-1 functions independently as a transmitter. It is not available when the WR-1 is mounted on a camera.

● **Release Delay**

Delay release of the shutter on cameras to which receiving WR-1 controllers are attached.

■ Pairing WR-R11a/WR-R11b Controllers with the WR-1

WR-R11a/WR-R11b controllers must be paired with the WR-1. ID mode connections are not supported. For more information, see the documentation for the WR-1.

1 Use the WR-1 as a transmitter or receiver.

Slide the **Tx/Rx/OFF** switch on the WR-1 to **[Tx]** to use the WR-1 as a transmitter or to **[Rx]** to use it as a receiver.

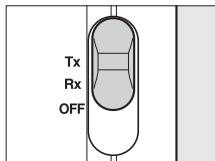

2 Set the WR-R11a/WR-R11b and WR-1 to the same channel.

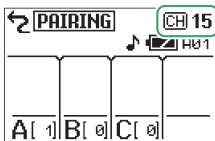
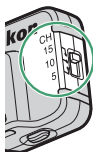

- The channel for the WR-R11a/WR-R11b can be chosen using the channel selector.
- To choose a channel for the WR-1, press ▲ or ▼. When using the WR-1 with the WR-R11a/WR-R11b, choose channel 5, 10, or 15.
- Here, all controllers are set to Channel 15.

-
- 3** Select [PAIRING] for [LINK MODE] in the WR-1 menus.



-
- 4** Highlight [PAIRING] in the WR-1 menus and press .

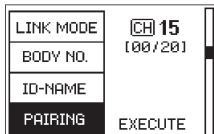

-
- 5** Turn on the camera to which the WR-R11a/WR-R11b is attached.

6 Highlight [EXECUTE] in the WR-1 menus and press  while simultaneously pressing the pairing button on the WR-R11a/WR-R11b.

LINK MODE	CH 15 [00/20]
BODY NO.	
ID-NAME	
PAIRING	EXECUTE

- When pairing devices, place them close together.
- The red and green LEDs on the WR-R11a/WR-R11b will flash on and off in sequence when pairing is complete.



- The WR-1 will display a message and the red and green LEDs will flash on and off in sequence. Press **MENU** to exit when the menus are displayed.

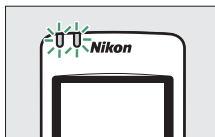

Using the WR-R11a/WR-R11b with SB-5000

Flash Units

A WR-R11a/WR-R11b mounted on a camera can be used as a transmitter to control remote flash units via radio AWL.

- This feature is available only with cameras that support radio AWL.
- For more information on available features and on adjusting settings, see the documentation for the camera and SB-5000.
- When reading the documentation for the SB-5000, replace all references to the WR-R10 with the WR-R11a/WR-R11b.
- For use with radio remote control, the SB-5000 must either be paired with the WR-R11a/WR-R11b or connected in PIN mode.
 - Pairing: Press the pairing button on the WR-R11a/WR-R11b to pair it with the SB-5000 (📖 26).
 - PIN: Enter the PIN for the camera on the SB-5000 (📖 30).

■ Features Available with the SB-5000

● Flexible Lighting

Radio AWL can be used to control flash units not visible from the camera or placed at distances of up to about 30 m (98 ft). It offers more flexibility in lighting choices and frees you from fretting over flash placement.

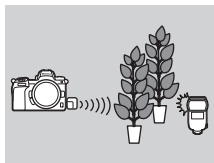

● Support for Multiple Remote Flash Units

Radio AWL allows simultaneous control of up to 18 flash units arranged freely in up to 6 groups.

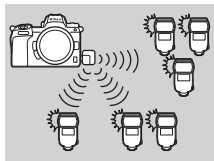

● Two-Way Communication

The camera provides real-time updates on the status and settings of remote flash units. Flash settings can also be adjusted from the camera.

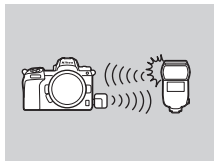

■ Connecting in Pairing Mode

1 Turn on the camera to which the WR-R11a/WR-R11b is attached.

2 Set the WR-R11a/WR-R11b to the desired channel.

Here we select Channel 15.

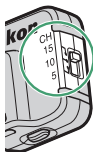

3 Select [Radio AWL] for [Flash control] > [Flash control] > [Wireless flash options] in the camera photo shooting menu.

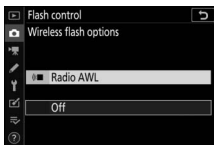

4 Select [Pairing] for [Wireless remote (WR) options] > [Link mode] in the camera setup menu.

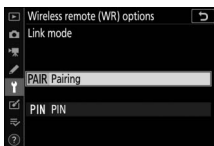

5 Rotate the flash unit power switch to REMOTE.

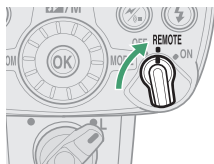

6 Press the wireless setting button to cycle through remote modes until radio control remote mode is displayed.

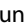
Keep cycling until the  icon is displayed.

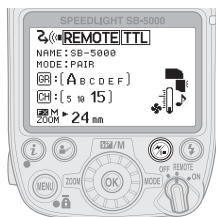

7 Set the flash unit to the same channel as the WR-R11a/WR-R11b.

- Press the **MENU** button, highlight [**CHANNEL**] in the “wireless item” tab, and press **OK**.
- Highlight the channel selected in Step 2 and press **OK**.
- Here we select Channel 15.



8 Choose [PAIRING] mode.

Select [LINK MODE] in the “wireless items” tab, then highlight [PAIRING] and press **OK**.

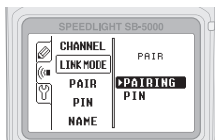

9 Highlight [PAIR] and press OK.

[EXECUTE] will be highlighted.

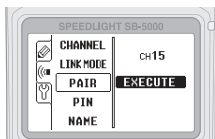

10 Press the **OK** button on the flash unit and the pairing button on the WR-R11a/WR-R11b.

- Wait no longer than about a second between pressing the **OK** button on the flash unit and the pairing button on the WR-R11a/WR-R11b.
- If desired, the pairing button on the WR-R11a/WR-R11b can be pressed before the **OK** on the flash unit.

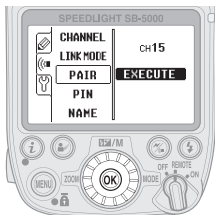

11 Confirm that pairing is complete.

- If pairing succeeds, the LINK indicator on the flash unit will blink green and orange. The LEDs on the WR-R11a/WR-R11b will blink alternately red and green.



- Pairing is complete when the green LED on the WR-R11a/WR-R11b lights, the flash unit LINK indicator turns green, and the flash unit displays the message “PAIRING COMPLETE”.

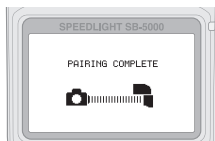

- You will not need to perform pairing again when connecting the devices in future.
- If pairing fails, for example because you waited too long between pressing the buttons on the flash unit and WR-R11a/WR-R11b, the flash unit will display the message “NO RESPONSE”. Repeat the pairing process from Step 9.

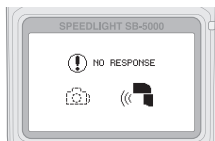

■ Connecting in PIN Mode

1 Turn on the camera to which the WR-R11a/WR-R11b is attached.

2 Set the WR-R11a/WR-R11b to the desired channel.

Here we select Channel 15.

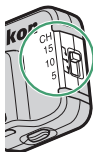

3 Select [Radio AWL] for [Flash control] > [Flash control] > [Wireless flash options] in the camera photo shooting menu.

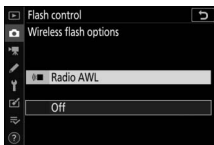

4 Go to the camera setup menu, select [Wireless remote (WR) options] > [Link mode], then highlight [PIN] and press .

A PIN-entry dialog will be displayed.

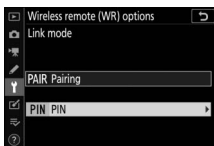

5 Enter a four-digit PIN and press



Enter a four-digit number of your choice. There is no need to re-enter the PIN in future.



6 Rotate the flash unit power switch to REMOTE.

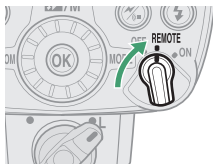

7 Press the wireless setting button to cycle through remote modes until radio-control mode is displayed.

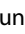
Keep cycling until the  icon is displayed.

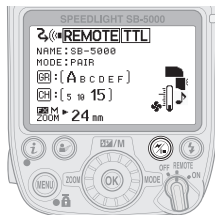

8 Set the flash unit to the same channel as the WR-R11a/WR-R11b.

- Press the **MENU** button, highlight [**CHANNEL**] in the “wireless item” tab, and press **OK**.
- Highlight the channel selected in Step 2 and press **OK**.
- Here we select Channel 15.



9 Choose [PIN] mode.

- Highlight [**LINK MODE**] in the “wireless item” tab, and press **OK**.
- Highlight [**PIN**] and press **OK**.



10 Enter the PIN.

- Highlight **[PIN]** in the “wireless item” tab, and press **OK**.
- Use the rotary multi selector to enter the PIN, pressing ◀ or ▶ to highlight digits and ▲ or ▼ to change.
- Enter the four-digit PIN selected in Step 5.
- Press **OK** when entry is complete; the connection to the camera will be initiated automatically.
- When the connection is established, the green LED on the WR-R11a/WR-R11b will light and the LINK indicator on the flash unit will turn green.



Channel Selection

When a WR-R11a/WR-R11b is used in combination with a WR-T10, WR-1, SB-5000, or other WR-R11a/WR-R11b controllers, each device must be set to the same channel for pairing or PIN-mode connections.



WR-R11a/
WR-R11b



WR-T10

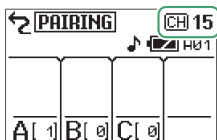

WR-1

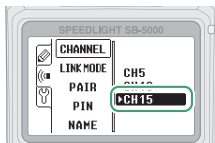

SB-5000

Devices paired or connected via PIN on different channels can be controlled separately simply by switching the channel.

- For example, a WR-T10 can be paired with three different WR-R11a/WR-R11b controllers, one for each of channels 5, 10, and 15, allowing different cameras to be controlled just by changing the channel selected with the WR-T10.

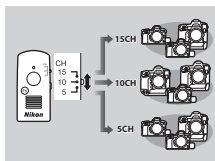

Technical Notes

Status LEDs

Device status is shown by the LEDs on the WR-R11a/WR-R11b and WR-T10.

WR-R11a/WR-R11b

The LED display for the WR-R11a/WR-R11b varies with the option selected for **[Flash control]** > **[Wireless flash options]** in the camera photo shooting menu.

■ **[Off]** Selected for **[Wireless Flash Options]**

The table below lists the possible states for the LEDs on the WR-R11a/WR-R11b when the controller is used with a WR-T10 or WR-1 or another WR-R11a/WR-R11b. Device status is shown by the green and red LEDs in combination. The following also applies in the case of cameras that do not have a **[Flash control]** > **[Wireless flash options]** item in the photo shooting menu.

Status/color		Description
Green	Red	
Off	Flashes rapidly (about twice a second)	The shutter-release button is pressed halfway. ¹

Status/color		Description
Green	Red	
Off	On	The shutter-release button is pressed all the way down. ¹
On	On	Exposure in progress. ²
Off	Flashes rapidly (2 flashes about twice a second)	The Fn button on a WR-T10 or on a WR-1 configured independently as a transmitter is pressed.
Flashes (at approximately 2-second intervals)	Off	The camera standby timer is off.
Flashes rapidly (about twice a second)	Off	The camera standby timer is on.
Flashes rapidly (about 5 times a second)	Off	Ready to pair.
Flash on and off in rapid succession, followed by green LED lighting for about a second		Pairing complete.
Flickers (flashes approximately 20 times a second)	Off	Ending pairing.
Light twice simultaneously		Pairing terminated.

- 1 Displayed when the shutter-release button on the master camera, WR-T10, or WR-1 is pressed. The same behavior is exhibited by the LEDs on all WR-R11a/WR-R11b controllers.
- 2 Applies to cameras other than the D3, D3X, D3s, D2H, D2Hs, D2X, D2Xs, D700, D300, D300s, D7000, D5100, D5000, D3100, and film cameras.

■ Option Other Than [Off] Selected for [Wireless Flash Options]

The possible states for the LEDs on WR-R11a/WR-R11b controllers used in combination with SB-5000 flash units are listed below. The state of the green and red lamps varies with connection or button status.

● Green LED

On: The controller has connected with the remote flash unit.

Off: The controller has not connected with the remote flash unit.

Flashes rapidly (about 5 times a second): The controller is ready for pairing (when pairing is complete, the green and red LEDs will flash on and off in succession before the green LED lights for about a second).

Flickers (flashes about 20 times a second): Pairing is ending (the green and red LEDs will light twice simultaneously when pairing ends).

● Red LED

On: The shutter-release button has been pressed all the way down. ¹

Flashes rapidly (about twice a second): The shutter-release button has been pressed halfway. ¹

Flashes rapidly (2 flashes about twice a second): The **Fn** button on a WR-T10, or on a WR-1 configured independently as a transmitter, has been pressed.

Blinks slowly (lights for about a second at approximately 2 second intervals): The controller has not connected with the remote flash unit.

Flashes slowly (lights for about 0.1 seconds at approximately 2 second intervals): The controller has not connected with the remote flash unit. ²

- 1 Displayed when the shutter-release button on the master camera, WR-T10, or WR-1 is pressed. The same behavior is exhibited by the LEDs on all WR-R11a/WR-R11b controllers.
 - 2 Applies when multiple cameras are assigned the same PIN and another camera is connected to an SB-5000 flash unit.
-

Disabling the LEDs

If the camera features a [**Wireless remote (WR) options**] item in the setup menu, the LEDs on the WR-R11a/WR-R11b can be disabled by selecting [**Off**] for [**LED lamp**].

First Use

It may take some time for the LEDs to begin flashing when the camera is first turned on after the WR-R11a/WR-R11b is attached, but photography can nevertheless proceed as normal.

WR-T10

Status	Description
Flashes rapidly (about twice a second)	The shutter-release button is pressed halfway.
Lights for about 2 seconds and then dims	The shutter-release button is pressed all the way down.
Flashes 2 times about twice a second	The Fn button is pressed.
About 7 long flashes	Ready to pair.
Lights once and then lights briefly 3 times in succession	Battery inserted.

Specifications

WR-R11a/WR-R11b Wireless Remote Controller

Type	
Type	WR-R11a, WR-R11b
Supported cameras	<ul style="list-style-type: none">• WR-R11a: Cameras with 10-pin remote terminals *• WR-R11b: Cameras with accessory terminals * <p>* Not compatible with the D1, D1H, D1X, D200, D90, COOLPIX A, COOLPIX P7800, COOLPIX P7700, COOLPIX P1000, or COOLPIX P950. Cannot be used with an MB-D100 attached to the D100.</p>
Wireless	
Channels	5 (2.425 GHz), 10 (2.450 GHz), 15 (2.475 GHz)
Maximum output power (EIRP)	<ul style="list-style-type: none">• WR-R11a: 6.4 dBm• WR-R11b: 7.5 dBm
Range (line of sight)	50 m (164 ft) between WR-R11a/WR-R11b wireless remote controllers (at a height of 1.2 m/3.9 ft) <ul style="list-style-type: none">• Without interference. Range may vary with signal strength, operating environment, and presence or absence of obstacles.
Pairing	Can be paired with up to 64 devices
Power consumption	
Power consumption	Approx. 120 mW maximum

Operating environment	
Temperature	-20 °C – +50 °C (-4 °F – +122 °F)
Humidity	85% or less (no condensation)
Dimensions/weight	
Dimensions	<ul style="list-style-type: none"> • WR-R11a: Approx. 44 × 26.5 × 23 mm/1.8 × 1.1 × 1 in. (width × height × depth) • WR-R11b: Approx. 34.5 × 26.5 × 14 mm/1.4 × 1.1 × 0.6 in. (width × height × depth)
Weight	<ul style="list-style-type: none"> • WR-R11a: Approx. 16 g/0.6 oz (body only) • WR-R11b: Approx. 8 g/0.3 oz (body only)

WR-T10 Wireless Remote Controller

Type	
Type	WR-T10
Wireless	
Channels	5 (2.425 GHz), 10 (2.450 GHz), 15 (2.475 GHz)
Maximum output power (EIRP)	8.85 dBm
Range (line of sight)	<p>20 m (66 ft) from WR-T10 to WR-R11a/WR-R11b (at a height of 1.2 m/3.9 ft)</p> <ul style="list-style-type: none"> • Without interference. Range may vary with signal strength, operating environment, and presence or absence of obstacles.

Power source	
Batteries	One CR2032 3 V lithium battery
Battery life	
Number of shots	Approx. 10,000 releases
Operating environment	
Temperature	-20 °C – +50 °C (-4 °F – +122 °F)
Humidity	85% or less (no condensation)
Dimensions/weight	
Dimensions	Approx. 28 × 60 × 8.5 mm/1.1 × 2.4 × 0.3 in. (width × height × depth)
Weight	Approx. 12 g/0.4 oz (including battery) Approx. 9 g/0.3 oz (body only)

- Unless otherwise stated, all figures assume a fresh battery and an ambient temperature of 23 ± 2 °C (73.4 ± 3.6 °F) as specified by the Camera and Imaging Products Association (CIPA). Range and battery life may drop at extreme temperatures.
- Refer to the camera manual for additional information on operating environment. Where the operating temperature range for this product differs from that for the camera, restrict the use of this product to whichever range is narrower.

No reproduction in any form of this manual, in whole or in part (except for brief quotation in critical articles or reviews), may be made without written authorization from NIKON CORPORATION.

NIKON CORPORATION

© 2020 Nikon Corporation



SB1103(11)
6MBJ2711-03