



Power Battery Pack

# MB-N14

Reference Guide

MB-N14 Model Name: N2312

- Read this document thoroughly before using the product.
- To ensure proper use of the product, be sure to read "For Your Safety" (page 4).
- After reading this document, keep it readily accessible for future reference.

# Table of Contents

- Introduction. . . . . 3**
  - Before You Begin. . . . . 3
  - For Your Safety. . . . . 4
- Using the MB-N14. . . . . 8**
  - Parts of the MB-N14: Names and Functions. . . . . 8
  - Attaching the MB-N14. . . . . 13
  - Inserting Batteries in the MB-N14. . . . . 15
  - Using an AC Adapter to Charge the Battery. . . . . 19
  - Using an AC Adapter to Power the Camera. . . . . 21
  - Checking the Level of the Batteries in the MB-N14. . . . . 23
  - Precautions for Use. . . . . 24
- Technical Notes. . . . . 25**
  - If the Holder-Chamber Cover Detaches. . . . . 25
  - Specifications. . . . . 26
  - Notices. . . . . 28

# Introduction

## Before You Begin

Before using this product, please read these instructions carefully. Also, see the documentation provided with the camera for details.

- Up to two EN-EL15c batteries can be inserted in the MB-N14 to provide power when the battery pack is attached to a camera below. Use the MB-N14 with compatible cameras only.
  - Z6III
  - Z 7II
  - Z 6II
- Be sure to update to the latest version of the camera firmware. With earlier versions, some functions may not be available or the camera may fail to correctly detect the product. The latest firmware is available from the Nikon Download Center.  
<https://downloadcenter.nikonimglib.com/>

# For Your Safety

To prevent damage to property or injury to yourself or to others, read "For Your Safety" in its entirety before using this product.

After reading these safety instructions, keep them readily accessible for future reference.



**DANGER:** Failure to observe the precautions marked with this icon carries a high risk of death or severe injury.



**WARNING:** Failure to observe the precautions marked with this icon could result in death or severe injury.



**CAUTION:** Failure to observe the precautions marked with this icon could result in injury or property damage.



## WARNING

**Do not disassemble or modify this product. Do not touch internal parts that become exposed as the result of a fall or other accident.**

Failure to observe these precautions could result in electric shock or other injury.

**Should you notice any abnormalities such as the product producing smoke, heat, or unusual odors, immediately remove the battery or disconnect the power source.**

Continued operation could result in fire, burns or other injury.

**Keep dry. Do not handle with wet hands. Do not handle the plug with wet hands.**

Failure to observe these precautions could result in fire or electric shock.

**Do not let your skin remain in prolonged contact with this product while it is on or plugged in.**

Failure to observe this precaution could result in low-temperature burns.

**Do not short the contacts of the battery pack or battery holder.**

Failure to observe this precaution could result in the batteries leaking, overheating, rupturing, or catching fire.



## WARNING

**Do not use this product in the presence of flammable dust or gas such as propane, gasoline or aerosols.**

Failure to observe this precaution could result in explosion or fire.

**Keep this product out of reach of children.**

Failure to observe this precaution could result in injury or product malfunction. In addition, note that small parts constitute a choking hazard. Should a child swallow any part of this product, seek immediate medical attention.

**Do not use batteries, chargers, AC adapters, or USB cables not specifically designated for use with this product. When using batteries, chargers, AC adapters, and USB cables designated for use with this product, do not:**

- **Damage, modify, forcibly tug or bend the cords or cables, place them under heavy objects, or expose them to heat or flame.**
- **Use travel converters or adapters designed to convert from one voltage to another or with DC-to-AC inverters.**

Failure to observe these precautions could result in fire or electric shock.

**Do not handle the plug when charging the product or using the AC adapter during thunderstorms.**

Failure to observe this precaution could result in electric shock.

**Do not handle with bare hands in locations exposed to extremely high or low temperatures.**

Failure to observe this precaution could result in burns or frostbite.



## CAUTION

**Remove the battery and disconnect the AC adapter if this product will not be used for an extended period.**

Failure to observe this precaution could result in fire or product malfunction.

**Do not leave the product where it will be exposed to extremely high temperatures for an extended period, such as in an enclosed automobile or in direct sunlight.**

Failure to observe this precaution could result in fire or product malfunction.

**Do not transport cameras or lenses with tripods or similar accessories attached.**

Failure to observe this precaution could result in injury or product malfunction.



## DANGER (Batteries)

### **Do not mishandle batteries.**

Failure to observe the following precautions could result in the batteries leaking, overheating, rupturing, or catching fire:

- Use only rechargeable batteries approved for use in this product.
- Do not expose batteries to flame or excessive heat.
- Do not disassemble.
- Do not short-circuit the terminals by touching them to necklaces, hairpins, or other metal objects.
- Do not expose batteries or the products in which they are inserted to powerful physical shocks.
- Do not step on batteries, pierce them with nails, or strike them with hammers.

---

### **Charge only as indicated.**

Failure to observe this precaution could result in the batteries leaking, overheating, rupturing, or catching fire.

---

### **If battery liquid comes into contact with the eyes, rinse with plenty of clean water and seek immediate medical attention.**

Delaying action could result in eye injuries.

---

### **Follow the instructions of airline personnel.**

Batteries left unattended at high altitudes in an unpressurized environment may leak, overheat, rupture, or catch fire.



## WARNING (Batteries)

### **Keep batteries out of reach of children.**

Should a child swallow a battery, seek immediate medical attention.

---

### **Keep batteries out of reach of household pets and other animals.**

The batteries could leak, overheat, rupture, or catch fire if bitten, chewed, or otherwise damaged by animals.

---

### **Do not immerse batteries in water or expose to rain.**

Failure to observe this precaution could result in fire or product malfunction. Immediately dry the product with a towel or similar object should it become wet.



## WARNING (Batteries)

**Discontinue use immediately should you notice any changes in the batteries, such as discoloration or deformation.**

**Cease charging EN-EL15c rechargeable batteries if they do not charge in the specified period of time.**

Failure to observe these precautions could result in the batteries leaking, overheating, rupturing, or catching fire.

---

**When batteries are no longer needed, insulate the terminals with tape.**

Overheating, rupture, or fire may result should metal objects come into contact with the terminals.

---

**If battery liquid comes into contact with a person's skin or clothing, immediately rinse the affected area with plenty of clean water.**

Failure to observe this precaution could result in skin irritation.

---

# Using the MB-N14

## Parts of the MB-N14: Names and Functions

The name and function of each of the MB-N14’s parts is listed below.

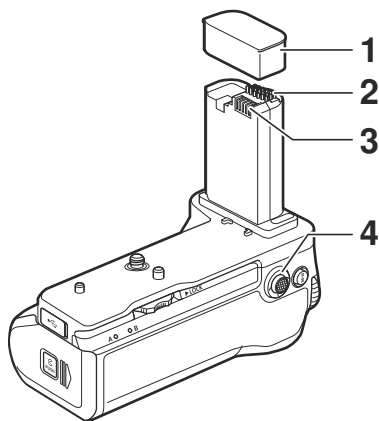

1	Contact cap	Protects the MB-N14’s power and signal contacts.
2	Signal contacts	—
3	Power contacts	—
4	Multi selector for vertical shooting	<p>Performs the same role as the multi selector on the camera. The roles performed by pressing the center during shooting can be chosen by the following camera menus. See the documentation provided with the camera for details.</p> <ul style="list-style-type: none"><li>• Z6III: Custom Settings f2 [<b>Custom controls (shooting)</b>] or g2 [<b>Custom controls</b>]</li><li>• Z 7II/Z 6II: Custom Settings f2 or g2 [<b>Custom controls</b>]</li></ul>



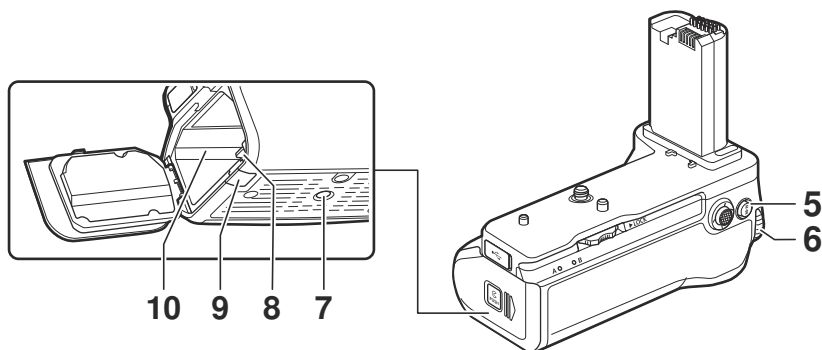

5	AF-ON button for vertical shooting	<p>Performs the roles assigned using the following camera menus. See the documentation provided with the camera for details.</p> <ul style="list-style-type: none"> <li>• Z6III: Custom Settings f2 [<b>Custom controls (shooting)</b>] or g2 [<b>Custom controls</b>]</li> <li>• Z 7II/Z 6II: Custom Settings f2 or g2 [<b>Custom controls</b>]</li> </ul>
6	Main command dial for vertical shooting	Performs the same roles as the matching controls on the camera. See the documentation provided with the camera for details.
7	Tripod socket	—
8	Battery-holder latch	Locks the battery holder in place after insertion.
9	Power connector cover	For use with optional EP-5B power connectors.
10	Battery-holder chamber	Where the battery holder is inserted.

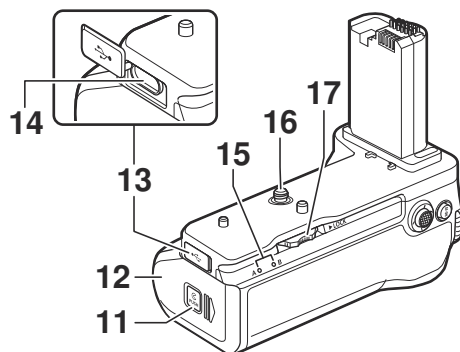

11	Holder-chamber latch	See "Inserting Batteries in the MB-N14" ( <a href="#">15</a> ) and "If the Holder-Chamber Cover Detaches" ( <a href="#">25</a> ).
12	Holder-chamber cover	
13	USB Power Delivery connector cover	For use with EH-8P AC adapters (connected via a UC-E25 USB cable) or EH-7P charging AC adapters, which can be used to charge the batteries or power the camera.
14	USB Power Delivery connector	
15	Charge lamp (×2)	Light while batteries are charging.
16	Mounting screw	Used when attaching the MB-N14 to the camera.
17	Attachment wheel	

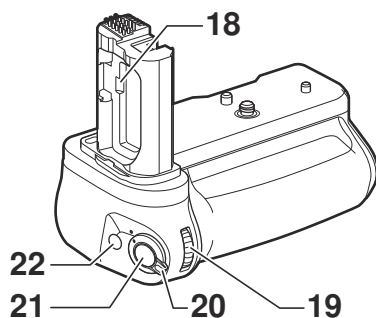

18	Battery-chamber cover holder	Holds the camera battery-chamber cover while it is removed from the camera.
19	Sub-command dial for vertical shooting	Performs the same roles as the matching controls on the camera. See the documentation provided with the camera for details.
20	Control lock	<p>Locks the controls on the MB-N14 to prevent accidental operation.</p> <ul style="list-style-type: none"> <li>The control lock is not a power switch. Use the power switch on the camera to turn the camera on or off.</li> </ul>
21	Shutter-release button for vertical shooting	Performs the same roles as the matching controls on the camera. See the documentation provided with the camera for details.
22	Fn button for vertical shooting	<p>Performs the roles assigned using the following camera menus. See the documentation provided with the camera for details.</p> <ul style="list-style-type: none"> <li>Z6III: Custom Settings f2 [<b>Custom controls (shooting)</b>], f3 [<b>Custom controls (playback)</b>], or g2 [<b>Custom controls</b>]</li> <li>Z 7II/Z 6II: Custom Settings f2 or g2 [<b>Custom controls</b>]</li> </ul>

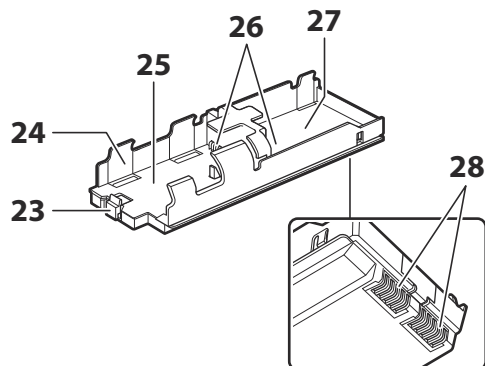

23	Battery latch	Locks the battery in Chamber A in place after insertion.
24	Battery holder	"Inserting Batteries in the MB-N14" ( <a href="#">15</a> ).
25	Battery chamber A	Holds one EN-EL15c rechargeable Li-ion battery.
26	Battery power terminals (×2)	"Inserting Batteries in the MB-N14" ( <a href="#">15</a> ).
27	Battery chamber B	Holds one EN-EL15c rechargeable Li-ion battery.
28	Battery holder power terminals	"Inserting Batteries in the MB-N14" ( <a href="#">15</a> ).

# Attaching the MB-N14

Before attaching the MB-N14, turn the camera off. To prevent unintended operation while attachment is in progress, leave the control lock on the MB-N14 in the **L** (locked) position until the process is complete.

## 1 Remove the contact cap from the battery pack.

Keep the contact cap in a safe place.

## 2 Remove the battery-chamber cover from the bottom of the camera and place it in the battery-chamber cover holder on the MB-N14.

If a battery is inserted in the camera, remove it.

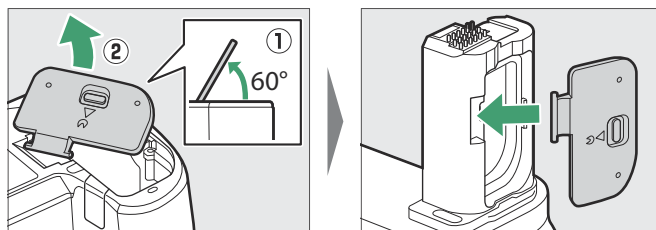

### 3 Attach the MB-N14 to the camera.

Rotate the attachment wheel in the direction shown by the ►LOCK arrow to secure the battery pack in place. Secure the MB-N14 in place by tightening the attachment wheel until it will turn no further.

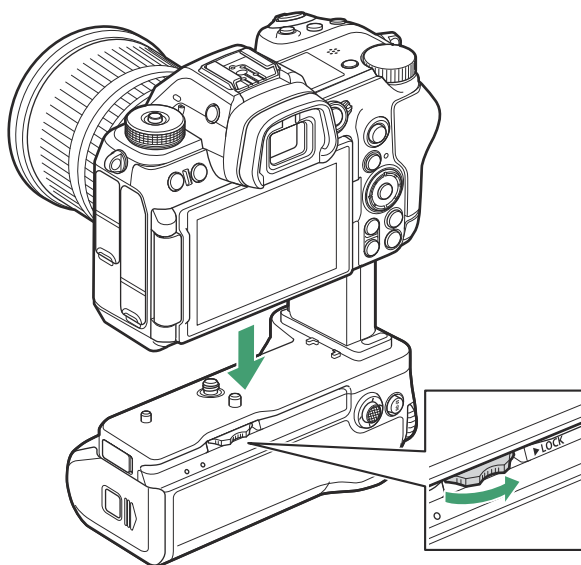

- A warning may appear in the camera shooting display if the MB-N14 is not securely attached. Securing the MB-N14 in place by tightening the attachment wheel until it will turn no further may resolve the issue.

---

### ✓ Removing the MB-N14

To remove the MB-N14, turn the camera off, then loosen the attachment wheel by turning it in the direction opposite to that used to attach it. After removing the MB-N14, remove the battery-chamber cover from the battery-chamber cover holder and reattach it to the camera.

- Reattach the contact cap to the MB-N14 when the battery pack is not in use.
-

# Inserting Batteries in the MB-N14

The MB-N14 can be used with up to two EN-EL15c rechargeable Li-ion batteries. Before inserting the batteries, turn the camera off. To prevent unintended operation while the batteries are being exchanged, you will also need to leave the control lock on the MB-N14 in the **L** (locked) position until the exchange is complete.

- 1** Keeping the holder-chamber latch pressed, slide the holder-chamber cover to the side and then swing it open.

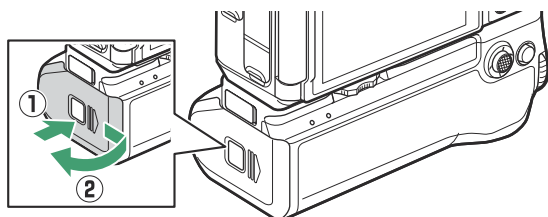

- 2** Press the battery-holder latch in the direction shown and remove the battery holder.

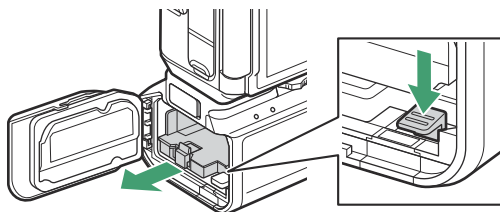

### 3 Insert the batteries in the battery holder.

Insert the batteries in the orientations shown. The battery latch will click into place when the battery in Chamber A is fully inserted.

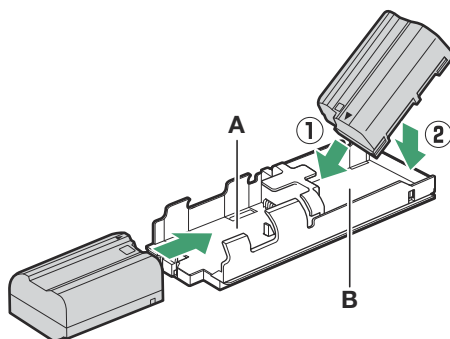

### 4 Insert the battery holder terminals-first.

Using the bottom of the battery holder to depress the battery-holder latch, slide the battery holder into the chamber terminals-first. Stop when the latch clicks back into place.

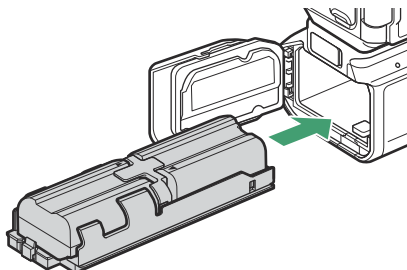

### 5 Close the holder-chamber cover and latch it by pressing and sliding it in the direction shown.

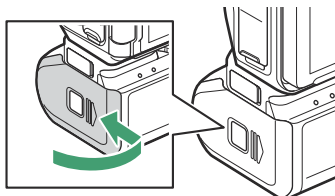



---

**Tip: Removing the Batteries**

Remove the holder and then remove the batteries as shown.

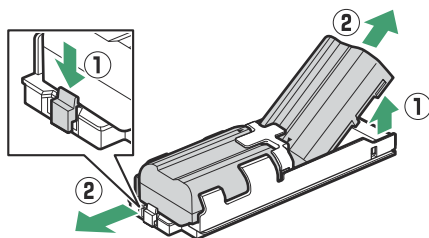
**Tip: Exchanging the Battery in Chamber A**

- The battery in Chamber A can be exchanged without removing the battery holder. Insert the battery as shown, stopping when the latch clicks into place.

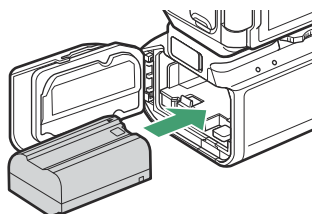

- The battery in Chamber A can be removed by pressing the latch as shown and sliding the battery from the holder.

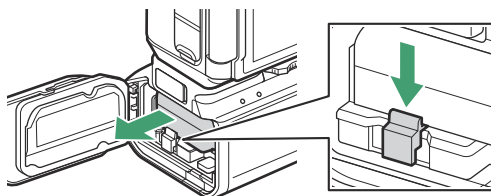

**Tip: Exchanging Batteries While Shooting**

When two batteries are inserted, you can replace the battery in Chamber A without turning the camera off. You may find this useful when using the camera continuously for extended periods. Be careful not to press the battery-holder latch and remove the battery holder while exchanging batteries.

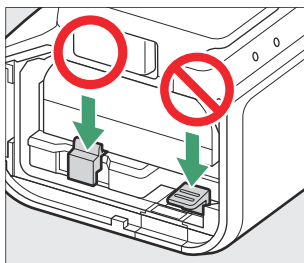
**Tip: Battery Order**

- If you are using only one battery, it can be inserted in either chamber.
- When two batteries are inserted, the battery in Chamber A will be used first. The camera will switch to the battery in Chamber B when the battery in Chamber A is exhausted.

**Tip: Compatible Batteries**

EN-EL15b and EN-EL15a batteries can be used in place of the EN-EL15c. Note, however, that fewer pictures can be taken on a single charge than with the EN-EL15c.

---

# Using an AC Adapter to Charge the Battery

Use an EH-8P AC adapter and a UC-E25 USB cable (featuring Type C connectors at both ends) or an EH-7P charging AC adapter to charge the batteries inserted in the MB-N14. The batteries can be charged even when the MB-N14 is removed from the camera.

## ✓ AC Adapters and USB Cables

The EH-8P AC adapter, UC-E25 USB cable, and EH-7P charging AC adapter are not supplied with this product.

### 1 Connect an EH-7P charging AC adapter or a UC-E25 USB cable connected to an EH-8P AC adapter to the USB Power Delivery connector of the MB-N14.

**EH-8P:** Connect one end of the UC-E25 USB cable (featuring Type C connectors at both ends) to the EH-8P AC adapter and the other to the USB Power Delivery connector of the MB-N14.

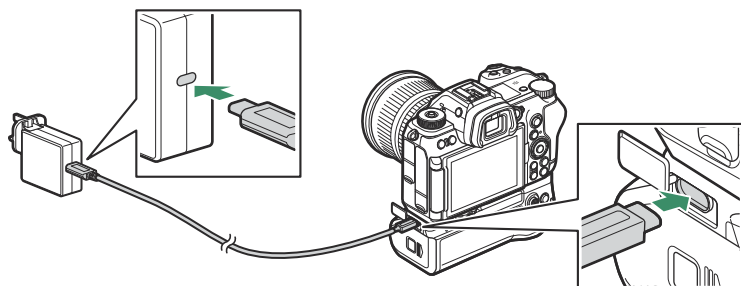

**EH-7P:** Connect the EH-7P to the USB Power Delivery connector of the MB-N14.

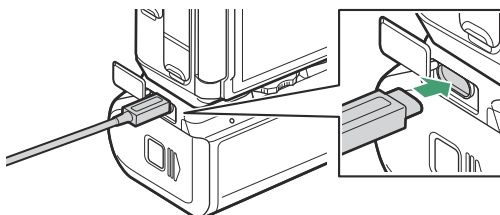

## 2 Plug the EH-8P or EH-7P into a household power outlet.

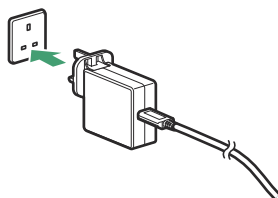

EH-8P

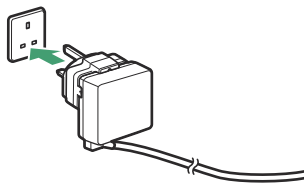

EH-7P

- The batteries charge while the camera is off. They also charge when the standby timer is off.
- The charge lamp for the battery that is currently charging will light while charging is in progress. The charge lamp turns off when charging is complete.

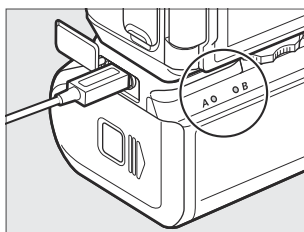

- The time needed to charge two fully-exhausted batteries is about 5 hours.
- If two batteries are inserted, the battery in Chamber B will charge first.
- The shape of the plug varies with the country or region of purchase.

## 3 When charging is complete, unplug the EH-8P or EH-7P and disconnect the cable from the USB Power Delivery connector of the MB-N14.

### ✓ Cautions: Charging Batteries

- The batteries will not charge if the cable is connected to the camera USB connector while the MB-N14 is attached. Connect the cable to the MB-N14's USB Power Delivery connector.
- The EH-8P and EH-7P can be used to charge EN-EL15c and EN-EL15b batteries only. They cannot be used to charge EN-EL15a batteries. Use an MH-25a battery charger instead.
- Charging errors caused by, for example, the battery pack overheating or attempts to charge an EN-EL15a are indicated by the charge lamp flashing rapidly for about 30 seconds before turning off.
- When charging batteries with the MB-N14 removed from the camera, be sure to attach the contact cap to the MB-N14.

# Using an AC Adapter to Power the Camera

An EH-7P charging AC adapter or a UC-E25 USB cable (featuring Type C connectors at both ends) connected to an EH-8P AC adapter can be connected to the USB Power Delivery connector of the MB-N14 to power the camera while the MB-N14 is attached to the camera.

## ✓ Cautions: Power Supply

- Power will be supplied to the camera only if a battery is inserted in one or both of Chambers A and B. The EH-8P and EH-7P will supply power when EN-EL15c, EN-EL15b, or EN-EL15a batteries are inserted.
- The battery will not charge while the camera is powered by an outside power source.

**1** After confirming that the camera is off, connect the AC adapter and MB-N14 in the same manner as when charging the battery ( [book 19](#) ).

**2** Plug the EH-8P or EH-7P into a household power outlet.

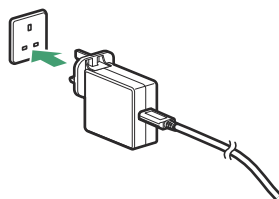

EH-8P

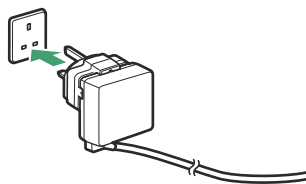

EH-7P

The shape of the plug varies with the country or region of purchase.

**3** Turn the camera on and select [ON] for [USB power delivery] in the setup menu.

The supply of power to the camera starts.

**4** Turn the camera off when not supplying the power to the camera.

Unplug the EH-8P or EH-7P from the outlet when not in use.

---

## ✓ Using an Optional EH-5d AC Adapter and EP-5B Power Connector

The optional EH-5d AC adapter and EP-5B power connector provide a steady supply of power when the camera must be left on for extended periods. When using the EH-5d with the MB-N14, insert the EP-5B in Chamber A before connecting it to the EH-5d.

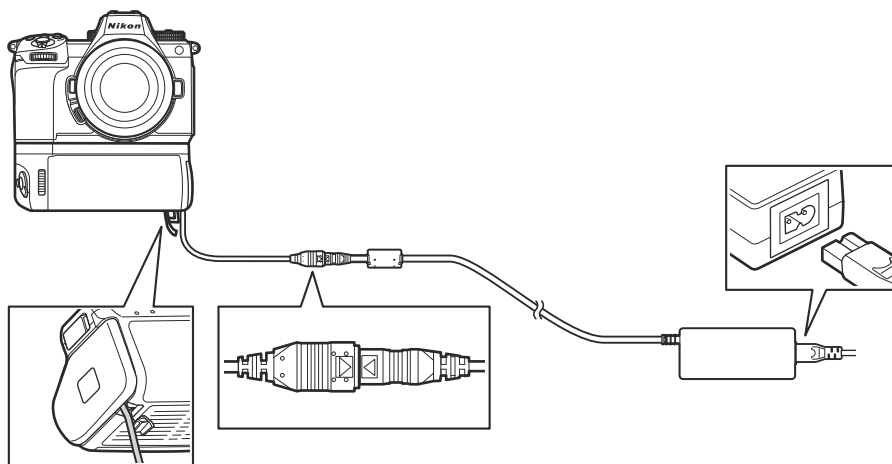

- EH-5c and EH-5b AC adapters can be used in place of the EH-5d.
  - The EP-5B can be inserted only in Chamber A.
  - After connecting the EP-5B, open the power connector cover on the MB-N14, position the power connector cable so that it passes through the power connector slot and close the holder-chamber cover.
  - There is no need to insert a battery in Chamber B. Batteries inserted in Chamber B are not used while the camera is being powered by an EH-5d and EP-5B.
  - The EH-8P and EH-7P cannot be used to charge the battery or supply power to the camera when the EP-5B is inserted.
-

# Checking the Level of the Batteries in the MB-N14

When the MB-N14 is connected and the camera is on, the level of the battery currently providing power to the camera is shown in the camera's shooting display and control panel.

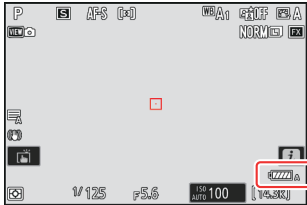

Z6III

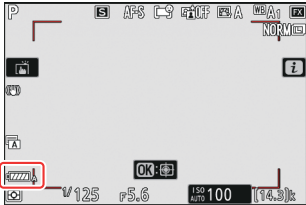

Z 7II/Z 6II

- The chamber containing the battery currently in use is indicated by an icon next to the battery indicator in the camera's shooting display.
- Additional information, including the battery age and precise battery level, can be viewed using the **[Battery info]** item in the camera setup menu.

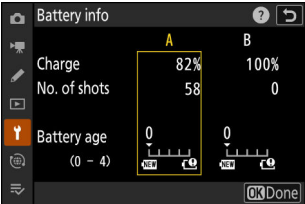
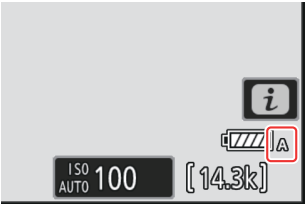

# Precautions for Use

Observe the following precautions when using the MB-N14.

- Touching the power/signal contacts with metal objects could cause a short-circuit; reattach the contact cap before storing or transporting the battery pack or charging the batteries with the pack not attached to the camera.
- A warning may appear in the camera shooting display if the MB-N14 is not securely attached. Securing the MB-N14 in place by tightening the attachment wheel until it will turn no further may resolve the issue.
- The camera memory card access lamp may light when the MB-N14 is attached to or removed from the camera.
- When using the camera with both the MB-N14 and an optional FTZ mount adapter attached, connect tripods to the tripod mount on either the lens or the MB-N14, not to the tripod mount on the FTZ.

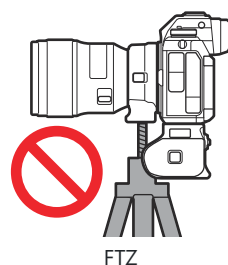
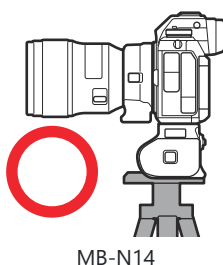
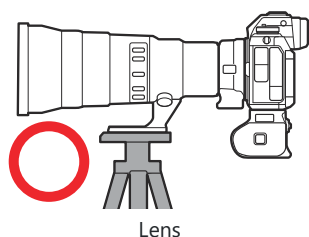

- The MB-N14 is not equipped with a power switch. Use the camera power switch to turn the camera on and off.

## ✓ Camera Warning Messages

If the camera displays one of the following messages, take the steps described below.

- If the camera displays the message [**Shutter release disabled. Recharge battery.**], insert a spare battery. Turn the camera off before proceeding if the battery in question is inserted in Chamber B or if there is only one battery in the holder and it is inserted in Chamber A.
- If the camera displays the message [**Error. Press shutter-release button to reset.**], press the shutter-release button. If the problem persists or recurs frequently, consult a Nikon-authorized service representative.



# Technical Notes

## If the Holder-Chamber Cover Detaches

In order to protect the holder-chamber cover from damage, it may detach if force is applied while it is open. The holder-chamber cover can be re-attached as shown.

- Before re-attaching the holder-chamber cover, slide the cover so that the hinge is visible.

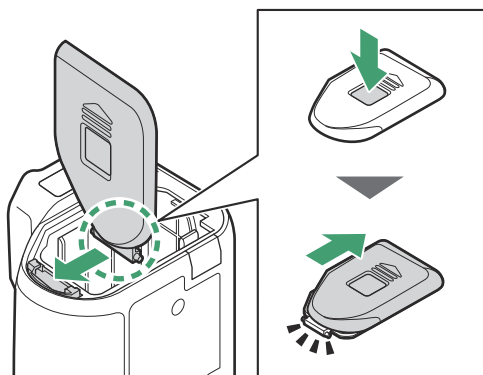

# Specifications

Power source	Up to two EN-EL15c rechargeable Li-ion batteries * * EN-EL15b/EN-EL15a batteries can also be used, but note that battery endurance (the number of pictures that can be taken or length of video footage that can be recorded on a single charge) is less than with the EN-EL15c.
Charging time	Approx. 5 hours • Time required to charge two EN-EL15c batteries using the EH-8P AC adapter or EH-7P charging AC adapter. Assumes an ambient temperature of 25 °C (77 °F) and that the batteries are exhausted.
Power Delivery connector	USB Type C. Can be used to connect the EH-7P charging AC adapter or the UC-E25 USB cable connected to the EH-8P AC adapter * but not for uploading pictures or other purposes. * The only batteries that can be charged using the EH-8P/EH-7P are the EN-EL15c and EN-EL15b.
Operating temperature	-10 °C – 40 °C (+14 °F – 104 °F) * * For the Z 7II/Z 6II, 0 °C – 40 °C (+32 °F – 104 °F).
Tripod socket	0.635 cm (1/4 in., ISO 1222)
Dimensions (W × H × D)	Approx. 138.5 × 113.5 × 76 mm (5.5 × 4.5 × 3 in.), excluding projections
Weight	• Approx. 455 g/1 lb 0.1 oz (with two EN-EL15c batteries) • Approx. 295 g/10.5 oz (without batteries)

\* Nikon reserves the right to change the appearance, specifications, and performance of this product at any time and without prior notice.

## ✔ Low Ambient Temperatures

The camera may not function at low temperatures (approximately 10 °C/50 °F or below) when powered by partially-charged batteries. In cold weather, charge one set of batteries before use and keep another in a warm place, ready to be exchanged as necessary. Once warmed, cold batteries may recover some of their charge.

---

**Tip: Battery Endurance with a Battery Pack**

Attaching an optional battery pack with two fully-charged EN-EL15c batteries increases the number of shots and length of video footage that can be recorded (battery endurance) by approximately 1.9 times over the amount that can be shot with the camera alone.

---

# Notices

- **Notices for Customers in the U.S.A.**

This device complies with part 15 of the FCC Rules. Operation is subject to the following two conditions: (1) This device may not cause harmful interference, and (2) this device must accept any interference received, including interference that may cause undesired operation.

## **Federal Communications Commission (FCC) Radio Frequency Interference Statement**

Note: This equipment has been tested and found to comply with the limits for a Class B digital device, pursuant to part 15 of the FCC Rules. These limits are designed to provide reasonable protection against harmful interference in a residential installation. This equipment generates, uses and can radiate radio frequency energy and, if not installed and used in accordance with the instructions, may cause harmful interference to radio communications. However, there is no guarantee that interference will not occur in a particular installation. If this equipment does cause harmful interference to radio or television reception, which can be determined by turning the equipment off and on, the user is encouraged to try to correct the interference by one or more of the following measures:

- Reorient or relocate the receiving antenna.
- Increase the separation between the equipment and receiver.
- Connect the equipment into an outlet on a circuit different from that to which the receiver is connected.
- Consult the dealer or an experienced radio/TV technician for help.

## CAUTIONS

### *Modifications*

The FCC requires the user to be notified that any changes or modifications made to this device that are not expressly approved by Nikon Corporation may void the user's authority to operate the equipment.

Nikon Inc., 1300 Walt Whitman Road, Melville, New York 11747-3064, U.S.A.

Tel.: 631-547-4200

### • **Notice for Customers in Canada**

CAN ICES-003 (B) / NMB-003 (B)

### • **Notices for Customers in Europe**

**CAUTION:** RISK OF EXPLOSION IF BATTERY IS REPLACED BY AN INCORRECT TYPE. DISPOSE OF USED BATTERIES ACCORDING TO THE INSTRUCTIONS.

This symbol indicates that electrical and electronic equipment is to be collected separately.



The following apply only to users in European countries:

- This product is designated for separate collection at an appropriate collection point. Do not dispose of as household waste.
- Separate collection and recycling helps conserve natural resources and prevent negative consequences for human health and the environment that might result from incorrect disposal.
- For more information, contact the retailer or the local authorities in charge of waste management.

[illegible]